

DASH NO.	M CODE	MADE FROM
----------	--------	-----------

GSD

KC-79-51

REVISIONS	
ISSUE	CHANGES
8	CN 32975 C REDRAWN WJM 05/16/91

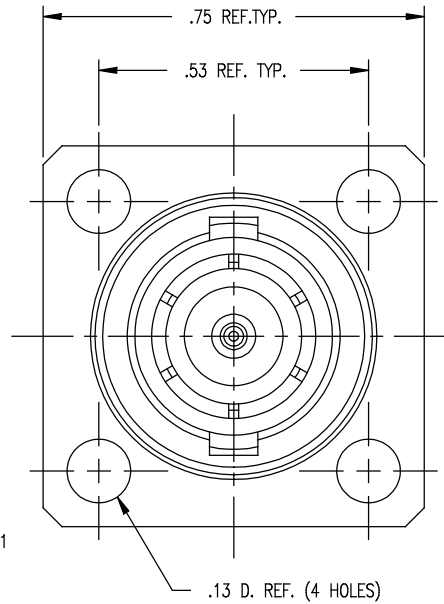
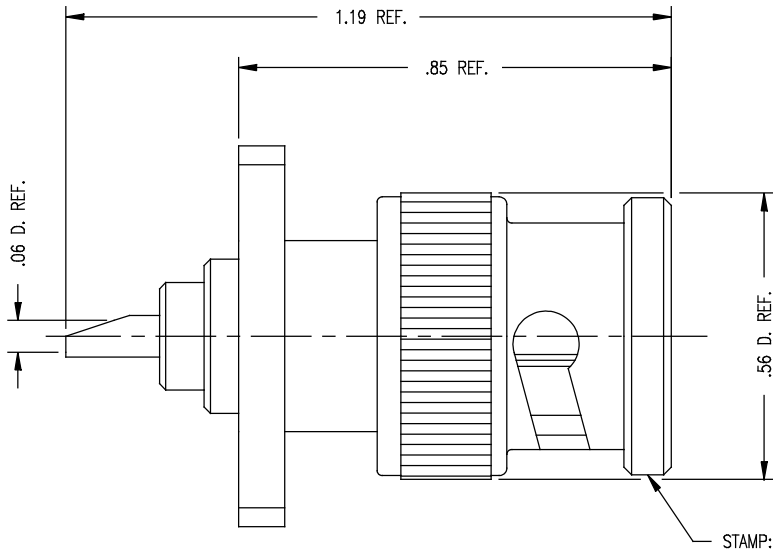

STAMP: KINGS KC-79-51

NOTES:

- INTERFACE PER MIL-STD-348, FIG. 301-1.
- MATERIALS:
 - INSULATOR: TEFLON, ASTM-D-1457
 - GASKET: SILICONE RUBBER, ZZ-R-765
 - OUTER CONTACT } BER. COPPER, ASTM-B-196
 - SPRING WASHER }
 - ALL OTHER METAL PARTS: BRASS, QQ-B-626
- FINISHES:
 - SPRING WASHER: SILVER PLATE, QQ-S-365
 - CENTER CONTACT: HARD GOLD PLATE, PER MIL-G-45204
 - ALL OTHER METAL PARTS: KINGS TARNISH RESISTANT FINISH (TR-5)
- ELECTRICAL CHARACTERISTICS:
 - NOMINAL IMPEDANCE: 50 OHMS
 - WORKING VOLTAGE: 500 VRMS
 - FREQUENCY RANGE: DC TO 4 GHz.

WJM1058

SCALE 4:1	
APPROX SURFACE AREA	
USED ON	
REF:	
RECEPTACLE, PANEL, BNC, M	
DRAWN WJM	DATE 05/16/91
DESIGN LJ	DATE 05/23/91
APPR.	DATE
 ELECTRONICS CO., INC. TUCKAHOE, NEW YORK 10707	

GSD

KC-79-51