

6

5

4

3

2

1

**MATERIAL AND FINISH:**

Insulator: Glass filled Nylon, black, UL-94-HB rated

Contacts: Phosphor Bronze, Tin plated

Spring: Spring Steel

**ENVIRONMENTAL**

Operating temperature: -30°C TO +70°C

**RoHS  
COMPLIANT**

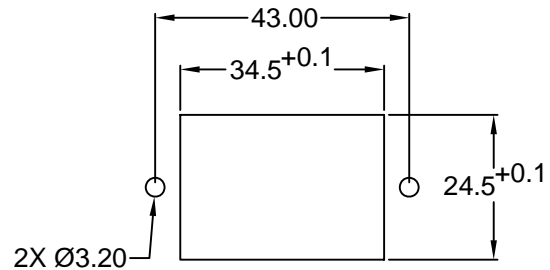
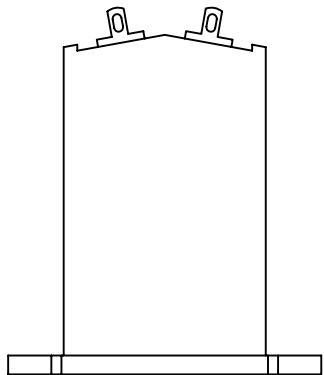

**RECOMMENDED  
PANEL CUTOUT**

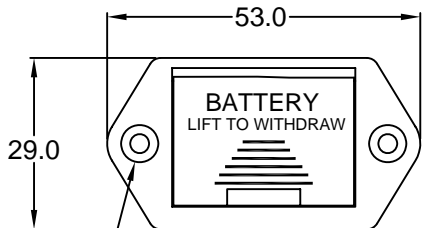

2X Ø3.20 THRU  
Ø6.35x45° CSK

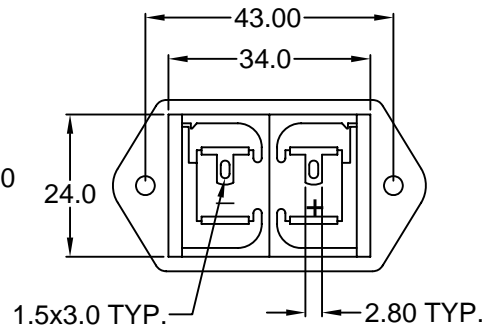
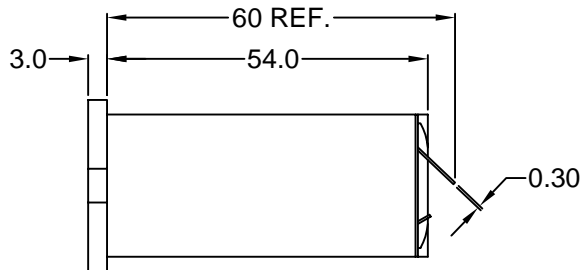

**REVISIONS**

REV	DATE	CHANGE	CHNG	CHK	APPR
A	12/98	UPDATED DRAWING	SS	JD	AH
B	12/27/99	REVISED DIM & SPECS.	PB	TD	SS
C	02/27/02	REVISED / UPDATED	GQ	TD	PB

TOLERANCE UNLESS OTHERWISE SPECIFIED	
X	± 1
X.X	± 0.4
X.XX	± 0.20

DRAWN BY	SS	DATE:	1/11/95
CHECK BY	JD	DATE:	1/12/95
APPR BY	AH	DATE:	1/12/95

**Power Dynamics, Inc.**  
 Phone: 973 560-0019 Whippany, New Jersey Fax: 973 560-0076

**PART: 1 CELL PP3 (6R61) 9V BATTERY HOLDER,  
 PANEL MOUNT, SOLDER TERMINALS**

**B23**

SIZE: A  
 SCALE: NTS

ALL DIMENSIONS FOR REFERENCE ONLY  
 DIMENSIONS ARE IN MILLIMETERS

SHEET 1 of 1  
 REV: C