

V.34 MODEM TRANSFORMERS

0574-1000-15 and 0574-1000-16

MECHANICALS

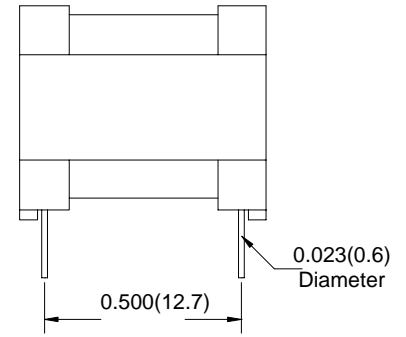
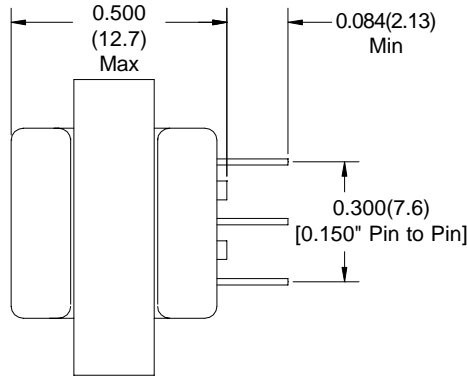
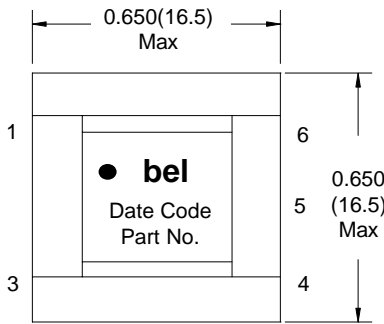

SCHEMATIC

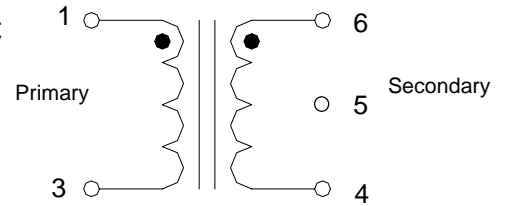

Pin 5 is not connected.
Transformer can be supplied without this pin if desired.

ELECTRICALS

SPECIFICATIONS		UNITS
Suitable for modem speeds up to:	56	Kb/s
Reflects 600 ohm at Pri with R_{load}	340	ohms
D.C. Resistance, 20°C, +/- 10%, Pri	120	ohms
D.C. Resistance, 20°C, +/- 10%, Sec	145	ohms
Frequency Response, 100 to 4000Hz	+/- 0.2	dB
Insertion Loss at 1KHz, 20°C	2.5 Max	dB
Return Loss vs 600 ohms at 1KHz	40 Typ	dB
Direct Current	None	--
Dielectric Test Pri-Sec, Pri to core	1250	VAC
Turns Ratio (Pri-Sec) 1KHz, +/- 1%	1:1	--
Longitudinal Balance 60 to 1000Hz	70 Min	dB
Longitudinal Balance 1000 to 4000Hz	60 Min	dB
Total Harmonic Distortion 600Hz @ -10dBm	- 86 Max	dB

TYPICAL FREQUENCY RESPONSE

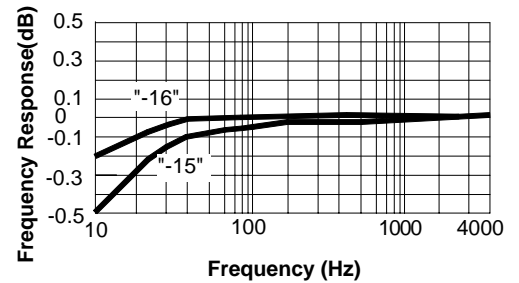

TYPICAL DISTORTION FIGURES (T.H.D.)

PART NUMBER	Ref	100 Hz	150 Hz	200 Hz	250 Hz	300 Hz	600 Hz
0574-1000-15	-10 dBm	-70	-77	-81	-84	-87	-93
0574-1000-16	-10 dBm	-76	-81	-84	-86	-88	-94

All dimensions are in inches(mm).
The dimension tolerance is +/- 0.01(0.25) unless otherwise specified.

Corporate Office

Bel Fuse Inc.
198 Van Vorst Street, Jersey City, NJ 07302-4496
Tel: 201-432-0463
Fax: 201-432-9542
E-Mail: BelFuse@belfuse.com
Internet: http://www.belfuse.com

Far East Office

Bel Fuse Ltd.
8F/8 Luk Hop Street
San Po Kong
Kowloon, Hong Kong
Tel: 852-2328-5515
Fax: 852-2352-3706

European Office

Bel Fuse Europe Ltd.
Preston Technology Management Centre
Marsh Lane, Preston PR1 8UD
Lancashire, U.K.
Tel: 44-1772-556601
Fax: 44-1772-888366