

Rev	AWO #	Description	Date	Appr
-		RELEASED	7/29/10	

APPROVED: _____
 DATE: _____ TITLE: _____

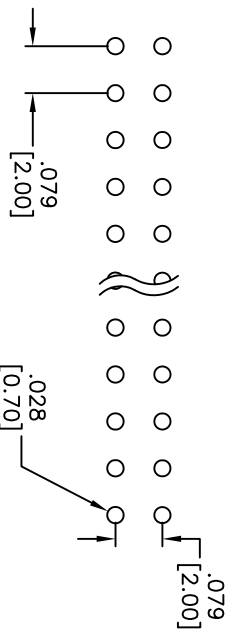

RECOMMENDED PCB LAYOUT

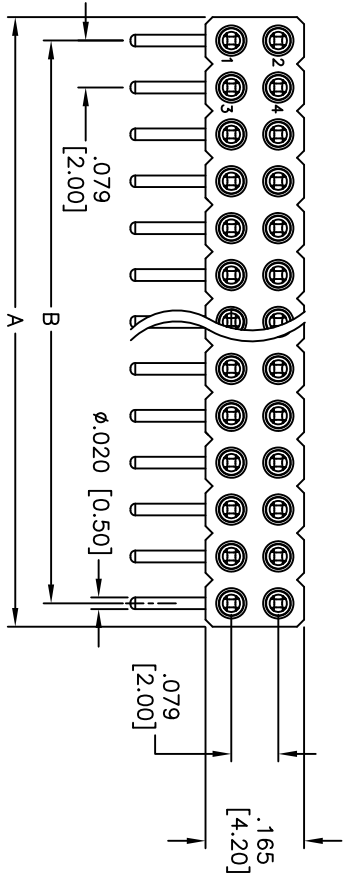
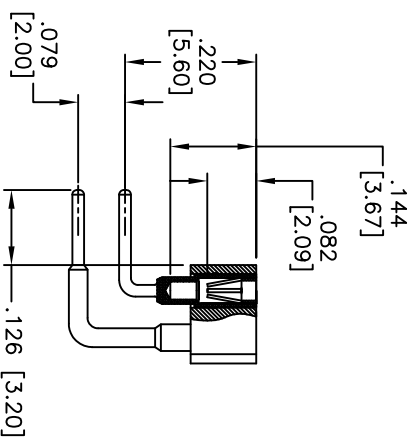
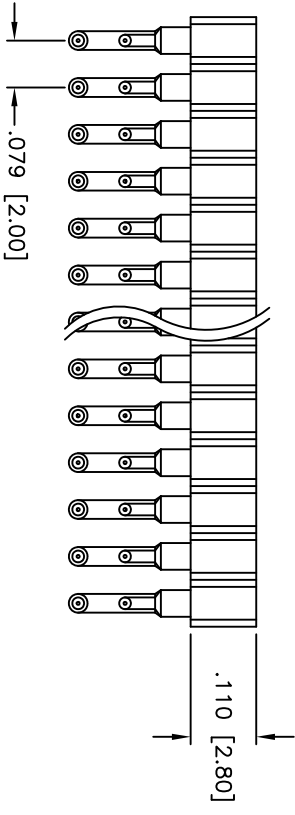

SPECIFICATIONS:
 Material: Thermoplastic, Glass reinforced, rated UL 94V-0
 Insulator color: Black
 Contacts: BeCu
 Sleeve: Brass

Plating:
 Inner contact: Gold flash over Nickel underplate
 Outer sleeve: Tin over Copper underplate overall

Electrical:
 Current rating: 3 Amp
 Contact resistance: 10 mohms max
 Dielectric Strength: Min 1000V rms
 Temperature Rating: -40°C to +105°C
 Environmental:
 Lead free, RoHS compliant
 Recommended soldering temp: 235°C for 5 seconds

Positions: 2 thru 40
 A = .079 [2.00] x No. of Positions
 B = .079 [2.00] x No. of Spaces

ADAM TECH
 909 Rahway Avenue, Union, NJ 07083
 Phone: 908-687-5000 Fax: 908-687-5710

TITLE: .079"x.079" MACHINED FEMALE HEADER,
 DUAL ROW, R/A, GOLD/TIN PLATED

UNLESS OTHERWISE SPECIFIED ALL DIMENSIONS ARE INCHES [MM]	
TOLERANCES: EXCEPT AS NOTED	
INCHES	HOLDS
.X ± .10	± .10
.XX ± .020	± .015
.XXX ± .015	± .010
APPROVALS	DATE
DRAWN	DY
CHECKED	
APPROVED	

SIZE	PART NO.	REV.
X	2SMC-2R-XX-1-GT	-
REF:	S00019C	SHEET 1 OF 1

