

UNAUTHORIZED USE OF THIS
DRAWING IS STRICTLY PROHIBITED

| DAR | REV | DESCRIPTION | APPVD | DATE |
|-----|-----|-----------------|-------|------|
| | A | INITIAL RELEASE | TJD | 6-12 |

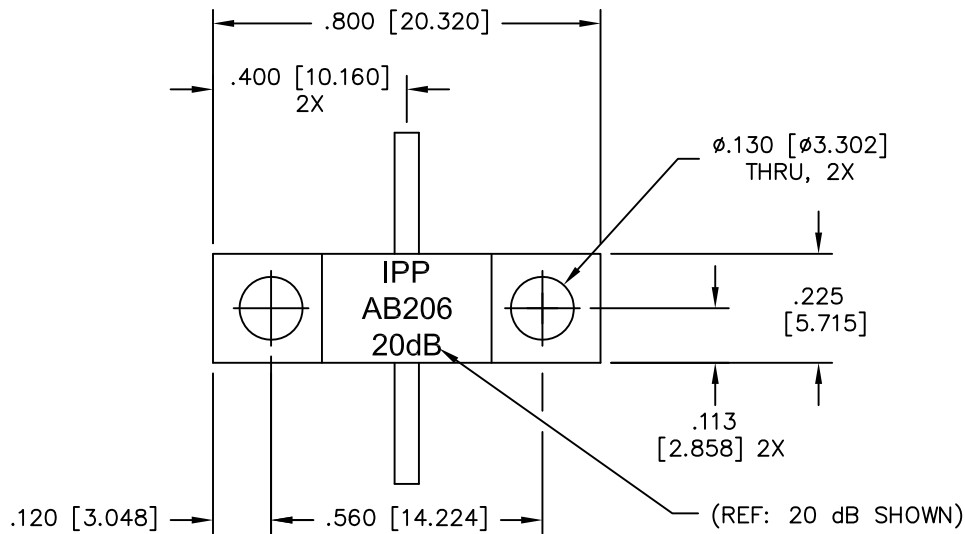
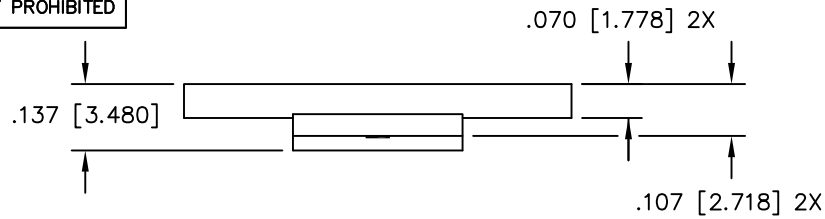

NOTES:

- LEAD MATERIAL: 99.99% PURE SILVER, .050 [1.270] WIDE x .005 [.127] THICK x .250 [6.350] MIN. LONG.
- SUBSTRATE MATERIAL: BeO COVER MATERIAL: Al₂O₃
- FLANGE MATERIAL: COPPER PLATING: NICKEL
- LEAD(S) WELDED TO SUBSTRATE.

ELECTRICAL SPECIFICATIONS

NOMINAL IMPEDANCE: 50 OHMS
 FREQUENCY: DC - 2.5 GHz.
 VSWR: 1.25:1
 INPUT POWER: 100 WATTS
 TEMPERATURE: -55°C TO 150°C

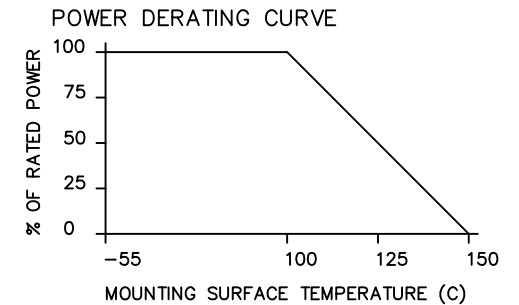

| PART NO. | VALUE | TOLERANCE |
|--------------|-------|-----------|
| IPP-AB206-2 | 2 dB | ±0.50 dB |
| IPP-AB206-3 | 3 dB | ±0.50 dB |
| IPP-AB206-4 | 4 dB | ±0.50 dB |
| IPP-AB206-6 | 6 dB | ±0.50 dB |
| IPP-AB206-8 | 8 dB | ±0.75 dB |
| IPP-AB206-10 | 10 dB | ±1.00 dB |
| IPP-AB206-20 | 20 dB | ±1.50 dB |

| | | | | | |
|--|------------------|--------------|---------------------------------------|---------------------|-----------|
| MATERIAL [2] [3] | DWN | DG | DATE | | |
| | ENG | TJD | DATE 6/12 | | |
| FINISH [3] | MANUF | DATE | TITLE ATTENUATOR, 100 WATT, FLANGE | | |
| TOLERANCE IN [MM] .XX ±.02 [.50] .XXX ±.010 [.254] | CAGE CODE: 437R2 | | SIZE B | P/N IPP-AB206-XX | REV. A |
| | SHEET OF 1 1 | SCALE 4:1 | | | |