

Rev	AWO #	Description	Date	Appr
-		RELEASED	1/5/11	

APPROVED: \_\_\_\_\_ TITLE: \_\_\_\_\_  
 DATE: \_\_\_\_\_

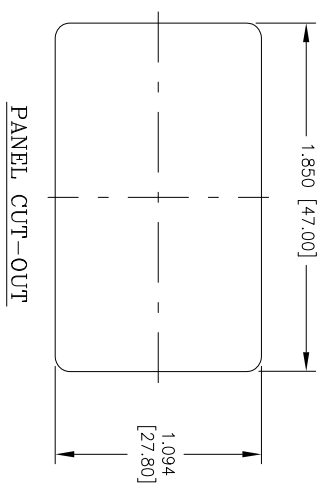
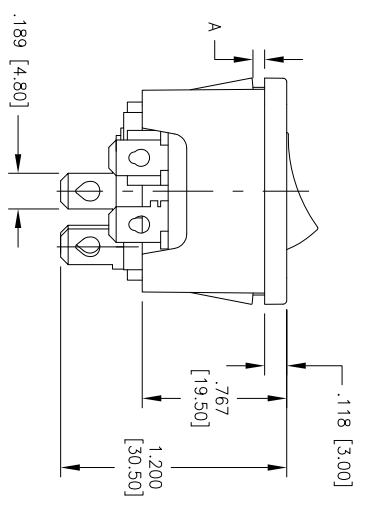
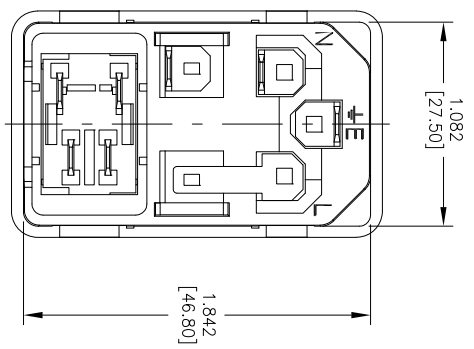
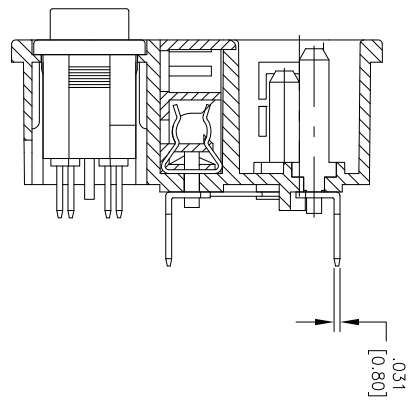
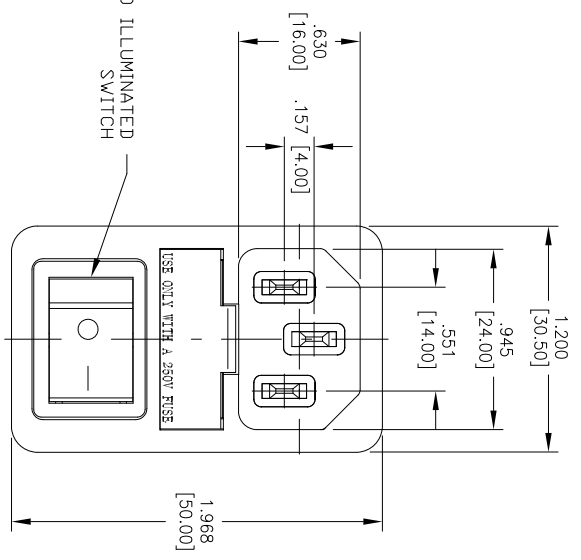

IEC-GS-1-XXX-RLS	A
IEC-GS-1-100-RLS	.039 [1.00]
IEC-GS-1-150-RLS	.059 [1.50]
IEC-GS-1-200-RLS	.079 [2.00]

**SPECIFICATIONS:**

**Material:**  
 Insulator: Thermoplastic, rated UL 94V-0  
 Insulator color: Black  
 Contacts: Brass  
 Plating:  
 Tin over Copper underplate  
 Electrical:  
 Operating voltage: 250 VAC max  
 Current rating: 15 Amps max (cUL)  
 10 Amps max (VDE)

**Environmental:**  
 Lead free, RoHS compliant.

**Environmental:**  
 Dielectric resistance: 100 Mohms min @ 500 VDC  
 Dielectric withstanding voltage: 2000 VAC for 1 minute  
 Temperature Rating:  
 Operating temperature: -65°C to +125°C

**UNLESS OTHERWISE SPECIFIED**  
 ALL DIMENSIONS ARE MM [INCHES]  
 TOLERANCES EXCEPT AS NOTED  
 INCHES HOLES  
 .XX ± .10 ØXX ± .10  
 .XX ± .020 ØXX ± .015  
 .XXX ± .015 ØXXX ± .010

**ADAM TECH**  
 909 Rahway Avenue, Union, NJ 07083  
 Phone: 908-687-5000 Fax: 908-687-5710

**IEC CONNECTOR, ISOLATED FUSE**  
 1.50mm SNAP IN, .187" [4.80] QC TERMINAL

**Environmental:**  
 Lead free, RoHS compliant.

**Environmental:**  
 Dielectric resistance: 100 Mohms min @ 500 VDC  
 Dielectric withstanding voltage: 2000 VAC for 1 minute  
 Temperature Rating:  
 Operating temperature: -65°C to +125°C

**UNLESS OTHERWISE SPECIFIED**  
 ALL DIMENSIONS ARE MM [INCHES]  
 TOLERANCES EXCEPT AS NOTED  
 INCHES HOLES  
 .XX ± .10 ØXX ± .10  
 .XX ± .020 ØXX ± .015  
 .XXX ± .015 ØXXX ± .010

APPROVALS	DATE
DRAWN AY	1/5/11
CHECKED JL	1/5/11
APPROVED	

SIZE	PART NO.	REV.
X	IEC-GS-1-XXX-RLS	-

REF: S00060T SCALE: NTS SHEET 1 OF 1