

**Type: RC-865**

**Product Description**

- 8.5mm Max.  $\phi$ , 6.5mm Max. Height.
- Inductance range: 100  $\mu$  H ~ 10mH
- Rated Current Range : 40 ~ 450mA



**Feature**

- Magnetically unshielded construction.
- Ideally Used in Printers, LCD TV, Copy Machine, Mainboard of the compounding machines, Adapters, etc as Power Supplies's inductors or DC-DC Converter inductors.
- RoHS Compliance

**Dimensions (mm)**

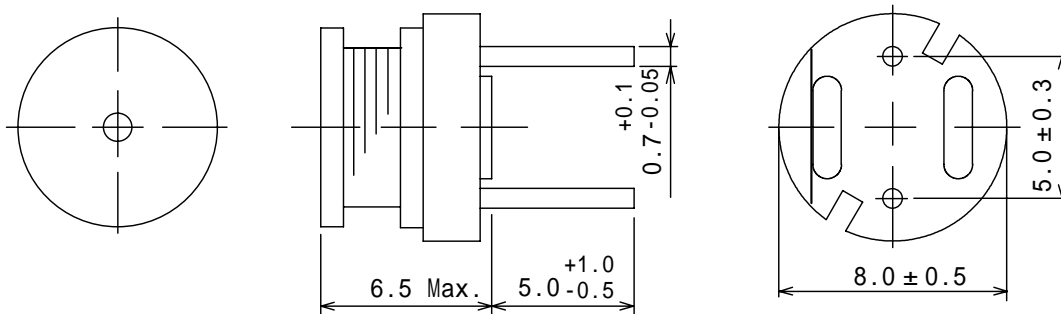

**Type: RC-865**
**Specification**

| Part Name    | Stamp | Inductance<br>[Within]<br>1 | Qu<br>[Min.]<br>1 | D.C.R.( )<br>[Max.]<br>(at 20 ) | Saturation current<br>(m A)[Ref.]<br>2 |
|--------------|-------|-----------------------------|-------------------|---------------------------------|--|
| RC865NP-1Ø1K | 101K  | 100 µ H ± 10%               | 25                | 0.65                            | 450                                    |
| RC865NP-121K | 121K  | 120 µ H ± 10%               | 25                | 0.80                            | 390                                    |
| RC865NP-151K | 151K  | 150 µ H ± 10%               | 35                | 1.1                             | 360                                    |
| RC865NP-181K | 181K  | 180 µ H ± 10%               | 35                | 1.3                             | 330                                    |
| RC865NP-221K | 221K  | 220 µ H ± 10%               | 35                | 1.5                             | 300                                    |
| RC865NP-271K | 271K  | 270 µ H ± 10%               | 35                | 2.1                             | 260                                    |
| RC865NP-331K | 331K  | 330 µ H ± 10%               | 35                | 2.6                             | 240                                    |
| RC865NP-391K | 391K  | 390 µ H ± 10%               | 35                | 3.0                             | 210                                    |
| RC865NP-471K | 471K  | 470 µ H ± 10%               | 40                | 3.8                             | 200                                    |
| RC865NP-561K | 561K  | 560 µ H ± 10%               | 40                | 4.2                             | 180                                    |
| RC865NP-681K | 681K  | 680 µ H ± 10%               | 40                | 5.3                             | 160                                    |
| RC865NP-821K | 821K  | 820 µ H ± 10%               | 40                | 5.9                             | 140                                    |
| RC865NP-1Ø2K | 102K  | 1.0mH ± 10%                 | 40                | 8.6                             | 130                                    |
| RC865NP-122K | 122K  | 1.2mH ± 10%                 | 40                | 9.8                             | 120                                    |
| RC865NP-152K | 152K  | 1.5mH ± 10%                 | 45                | 11.0                            | 110                                    |
| RC865NP-182K | 182K  | 1.8mH ± 10%                 | 45                | 13.0                            | 100                                    |
| RC865NP-222K | 222K  | 2.2mH ± 10%                 | 45                | 15.0                            | 90                                     |
| RC865NP-272K | 272K  | 2.7mH ± 10%                 | 45                | 18.0                            | 80                                     |
| RC865NP-332K | 332K  | 3.3mH ± 10%                 | 50                | 24.0                            | 75                                     |
| RC865NP-392K | 392K  | 3.9mH ± 10%                 | 50                | 27.0                            | 65                                     |
| RC865NP-472K | 472K  | 4.7mH ± 10%                 | 45                | 40.0                            | 60                                     |
| RC865NP-562K | 562K  | 5.6mH ± 10%                 | 45                | 52.0                            | 55                                     |
| RC865NP-682K | 682K  | 6.8mH ± 10%                 | 45                | 61.0                            | 50                                     |
| RC865NP-822K | 822K  | 8.2mH ± 10%                 | 45                | 70.0                            | 45                                     |
| RC865NP-1Ø3K | 103K  | 10mH ± 10%                  | 45                | 86.0                            | 40                                     |

1.Measuring frequency :L: 1 kHz; Qu : 100 kHz

2. Saturation current: The DC current at which the inductance decreases to 95% of it's initial value.