

Primary core built-in type current transformer



Model:TA16E-03

Characteristics:

primary coil built-in, PCB welding, Epoxy resin encapsulated, permalloy core.

Technical index:

Mounting type: PCB
Material of the core: Permalloy
Flame resistance: UL94-V0
Execution standard: GB1208-2006
Operating temperature: $-35^{\circ}\text{C} \sim +85^{\circ}\text{C}$
Storage temperature: $-45^{\circ}\text{C} \sim +95^{\circ}\text{C}$
Frequency range: 20Hz-20KHz
Dielectric strength: 3KV 50Hz 1min



Electrical parameters:

Rated input	0-0.1	A
Max.input		A
Rated output	0-2.5	mA
Turns ratio	20: 800	
Accuracy	± 1	%
Linearity	≤ 0.1	%
Phase difference	$\leq 10'$	
max: Max. sampling resistance	300	Ω
Weight	13	g

Schematic diagram:

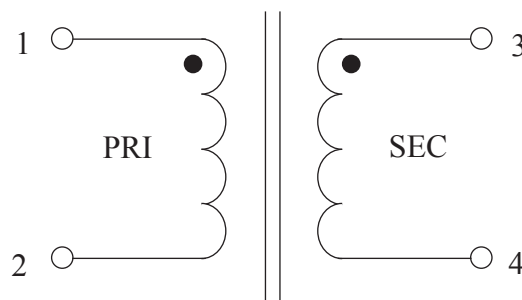

Dimensions (in mm) :

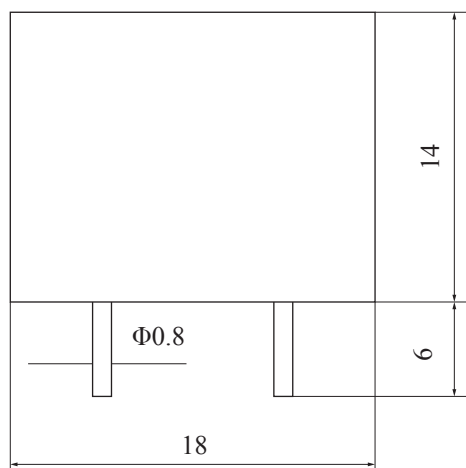

Front view

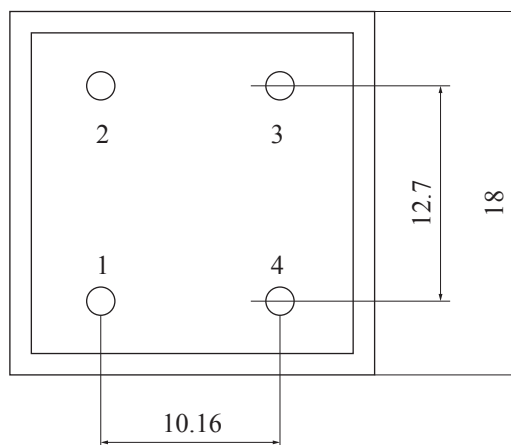

Bottom view