

**PLEASE CHECK WWW.MOLEX.COM FOR LATEST PART INFORMATION**

**Part Number:** [0197124001](#)  
**Status:** **Active**  
**Description:** PCB Tab Quick Disconnect, Male, for Wire, Box, Tab 2.79mm (.110") x 0.51mm (.020")

**Documents:**

[Drawing \(PDF\)](#) [RoHS Certificate of Compliance \(PDF\)](#)

**Agency Certification**

UL E79133

**General**

Product Family Quick Disconnects  
 Series [19712](#)  
 Crimp Quality Equipment Yes  
 Product Name PCB Tab  
 Type Quick Disconnect

**Physical**

Barrel Type Closed  
 Gender Male  
 Glow-Wire Compliant No  
 Insulation None  
 Lock to Mating Part None  
 Material - Plating Mating Tin  
 Material - Plating Termination Tin  
 Orientation PCB Straight Tab  
 Packaging Type Bag  
 Plating min: Mating (µin) 150  
 Plating min: Mating (µm) 3.75  
 Plating min: Termination (µin) 150  
 Plating min: Termination (µm) 3.75  
 Polarized to Mating Part No  
 Tab Thickness 0.51mm (.020")  
 Tab Width 2.79mm (.110")  
 Termination Interface: Style Through Hole  
 Wire Insulation Diameter N/A  
 Wire Size AWG N/A

**Electrical**

Voltage - Maximum N/A

**Material Info**

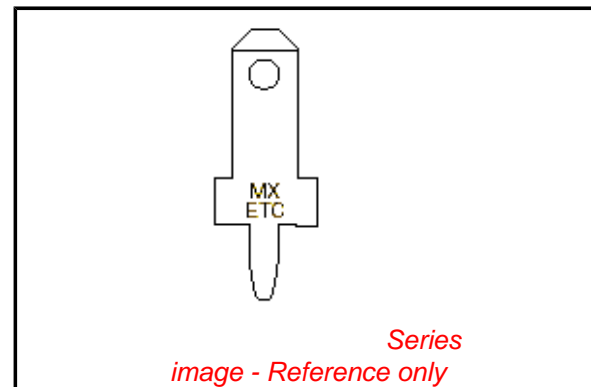

**EU RoHS**

**ELV and RoHS  
Compliant**  
**REACH SVHC  
Contains SVHC: No**  
**Halogen-Free  
Status**

**China RoHS**



**Not Reviewed**

**Need more information on product  
environmental compliance?**

Email [productcompliance@molex.com](mailto:productcompliance@molex.com)  
 For a multiple part number RoHS Certificate of  
 Compliance, [click here](#)

Please visit the [Contact Us](#) section for any  
 non-product compliance questions.

**Search Parts in this Series**

[19712Series](#)

MATERIAL NUMBER	ENGINEERING NUMBER	CUSTOMER NUMBER	CARRIER	SEE PLATING NOTE 6 & 7.	DIMENSION "A"	DIMENSION "B"
19724001	19712-4001	4001	LOOSE	TIN/LEAD	.362	.110
19724003	19712-4003	-	STRIP	TIN/LEAD	.362	.110

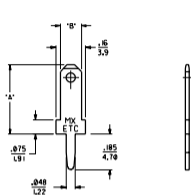

PROGRESSION ON

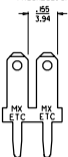

ISOMETRIC VIEW

RECOMMENDED P.W.B. HOLE LAYOUT



NOTES:

1. BARE EDGES PERMISSIBLE AT CARRIER CUT OFF.
2. MATERIAL: BRASS.
3. MATERIAL THICKNESS: .020  $\pm$  .001 / .0151  $\pm$  .003
4. TAB CONFORMS TO NEMA SPECIFICATIONS.
5. ALL DIMENSIONS AND NOTES ARE REFERENCE ONLY UNLESS NOTED.
6. PLATING: 98/10 TIN LEAD 150  $\mu$  IN (3.8  $\mu$  M) MIN THICKNESS.
7. FINISH MATTE

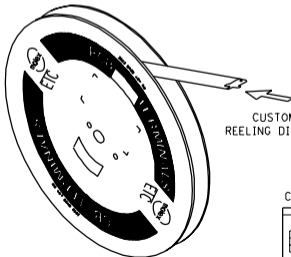

CUSTOMER REELING DIRECTION

CUSTOMER DRAWING

REVISIONS			
REV	DESCRIPTION	DATE	BY
E	ADD FINISH: ETC001-801		
D	INC. 09/21-2600		
C	LOAD ORIENTATION: ETC001-801		
B	REMOVE NON-PLATED PARTS FROM CHART (TABLES 8T/9 JM)		
A	RELEASE TO CUSTOMER	07/09/95	JM

REVISE ONLY ON CAD SYSTEM			
DATE	DESCRIPTION	DATE	BY
10/21/95	QUICK DISCONNECT PCB MOUNTABLE		
	.110 X .020 TAB		

DATE	CHKD	BY	RWD	DATE
DATE		CHKD	BY	RWD

**SEE CHART** SD-19712-400