

## Model 1452 Medium Power, N or SMK Connectors Convection Cooled

dc to 4.0 GHz  
 25 Watts

 **RoHS**



### Features

- /// Optimized for Wireless OEM and Test Applications.
- /// Designed to meet environmental requirements of MIL-D-39030.
- /// Quality Injection Molded Connector.
- /// 5 Kilowatts Peak Power.

### Specifications

**NOMINAL IMPEDANCE:** 50 Ω

**FREQUENCY RANGE:** dc to 4.0 GHz

#### MAXIMUM SWR\*:

Frequency (GHz)	SWR
dc - 2	1.10
2 - 4	1.20

**POWER RATING:** 25 watts average (mounted horizontally assuming unobstructed air flow and natural convection around unit) @ 25°C ambient temperature, derated linearly to 2.5 watts @ 125°C. 5 kilowatts peak (5 μsec pulse width; 0.25% duty cycle).

**TEMPERATURE RANGE:** -55°C to +125°C

**TEST DATA:** Swept data plots of SWR from 50 MHz to 4 GHz is available at additional cost.

**CONNECTOR:** Type N or SMK (2.92mm) connectors mate nondestructively with MIL-C-39012 connector.

Connector Options	Type/Description
1	SMK, Female
2	SMK, Male
3	Type N, Female
4	Type N, Male

**CONSTRUCTION:** Black, finned aluminum body, stainless steel connector; gold plated beryllium copper contacts.

**WEIGHT:** 150 g (5.2 oz)

**PHYSICAL DIMENSIONS:**

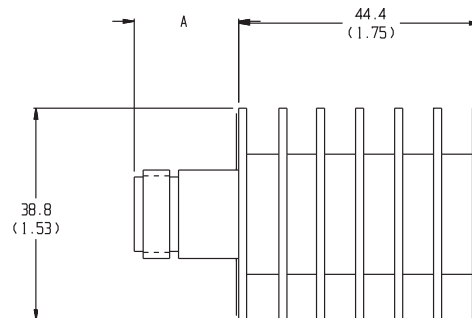

Model #	DIM A	Connector Type
1452-1	12.7 (0.50)	2.92mm female
1452-2	14.0 (0.55)	2.92mm male
1452-3	15.0 (0.59)	N female
1452-4	22.9 (0.90)	N male

**NOTE:** All dimensions are given in mm (inches) and are maximum, unless otherwise specified.