

Rev	AWG #	Description	Date	Appr
-		RELEASED	7/28/04	

APPROVED: \_\_\_\_\_

DATE: \_\_\_\_\_ TITLE: \_\_\_\_\_

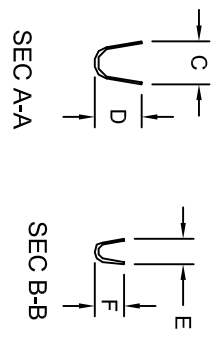
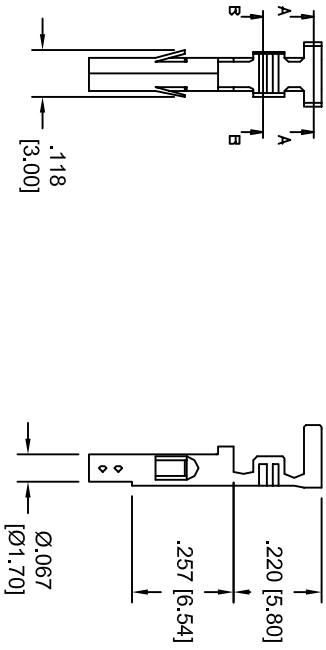

WIRE AWG	DIMENSIONS			
	C	D	E	F
22 ~ 26	.134 [3.4]	.130 [3.3]	.098 [2.5]	.090 [2.3]
18 ~ 22	.157 [4.0]	.177 [4.5]	.098 [2.5]	.090 [2.3]
16	.157 [4.0]	.177 [4.5]	.110 [2.8]	.106 [2.7]

SUPPLIED LOOSE PCS IN ANTI-ESD BAG

**SPECIFICATIONS:**

- Material: Brass
- Plating: Tin over Copper underplate
- Electrical: Operation voltage: 250 VAC max  
Current rating: 5 Amps max
- Mechanical: Packaging: Loose pcs in Anti-ESD bag

UNLESS OTHERWISE SPECIFIED  
ALL DIMENSIONS ARE INCHES [MM]  
TOLERANCES: EXCEPT AS NOTED  
INCHES

.X	± .10	ØX	± .10
.XX	± .020	ØXXX	± .015
.XXX	± .015	ØXXXX	± .010

APPROVALS: \_\_\_\_\_ DATE: \_\_\_\_\_

**ADAM TECH**

909 Rahway Avenue, Union, NJ 07083  
Phone: 908-687-5000 Fax: 908-687-5710

TITLE: CRIMP TERMINAL, MINI FIT JR, 4.20mm  
DMH SERIES HOUSING

DRAWN	SS	7/28/04	SIZE	PART NO.	REV.
CHECKED			X	DMH-C-B	-
APPROVED			REF:	SCALE: NTS	SHEET 1 OF 1