

SAW Filter 915.0MHz for ISM900 (High Attenuation)
Part No: MA03704

Model: TA915FC
Rev No: 2

A. MAXIMUM RATING:

1. Input Power Level: 10dBm
2. DC voltage: 0V
3. Operating Temperature: -40°C to +85°C
4. Storage Temperature: -40°C to +85°C

B. ELECTRICAL CHARACTERISTICS:

Characteristics	Min.	Typ.	Max.
Center frequency Fc (MHz)	-	915.0	-
Insertion loss within 902 ~ 928MHz IL (dB)	-	2.9	3.5
Amplitude ripple (p-p) within 902 ~ 928MHz (dB)	-	1.4	2.0
Attenuation (Reference level from 0dB)			
DC ~ 800MHz (dB)	25,0	33,0	-
800 ~ 880MHz (dB)	20,0	37,0	-
960 ~ 1280MHz (dB)	35,0	38,0	-
1280 ~ 2000MHz (dB)	20,0	35,0	-
Temperature coefficient of frequency TCf (ppm/K)	-	-30	-
Source impedance Z _S (Ω)	-	50	-
Load impedance Z _L (Ω)	-	50	-

Note 1: The standard definitions is in JIS C 6703.

SAW Filter 915.0MHz for ISM900 (High Attenuation)
Part No: MA03704

Model: TA915FC
Rev No: 2

C. MEASUREMENT CIRCUIT:

HP Network analyzer

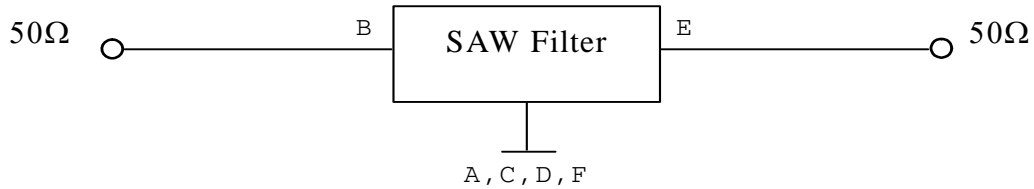

D. OUTLINE DRAWING:

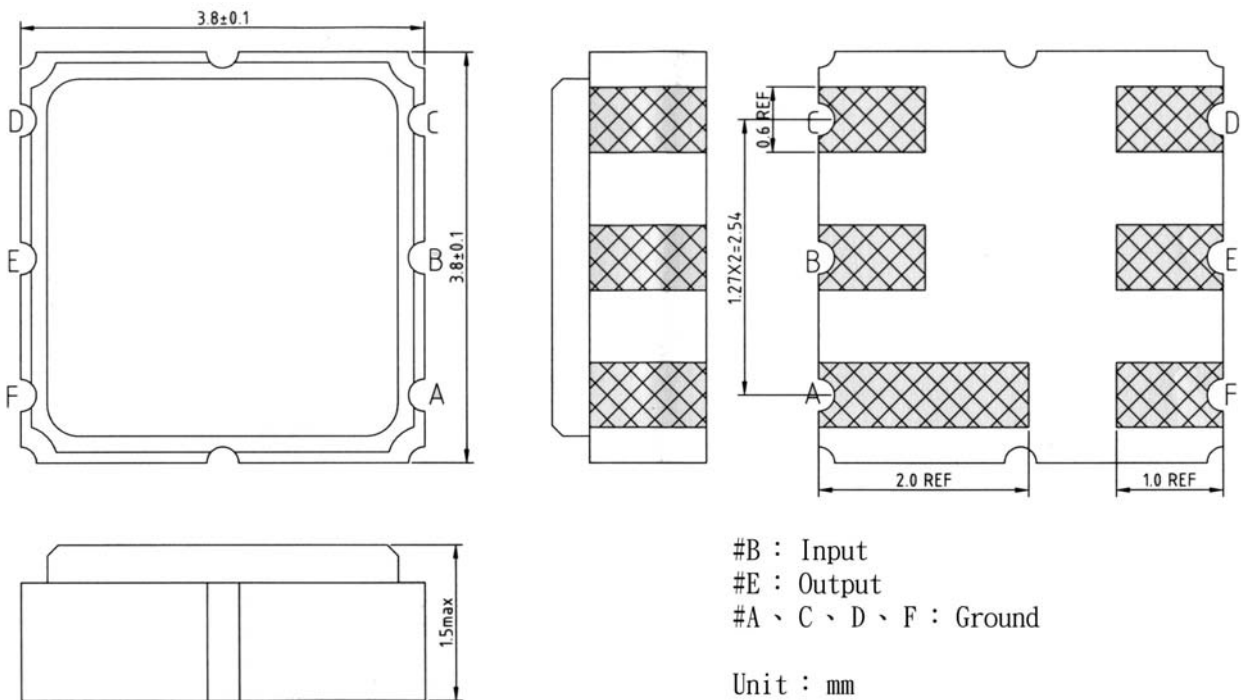

SAW Filter 915.0MHz for ISM900 (High Attenuation)
Part No: MA03704

Model: TA915FC
Rev No: 2

E. FREQUENCY CHARACTERISTICS:

Transfer function

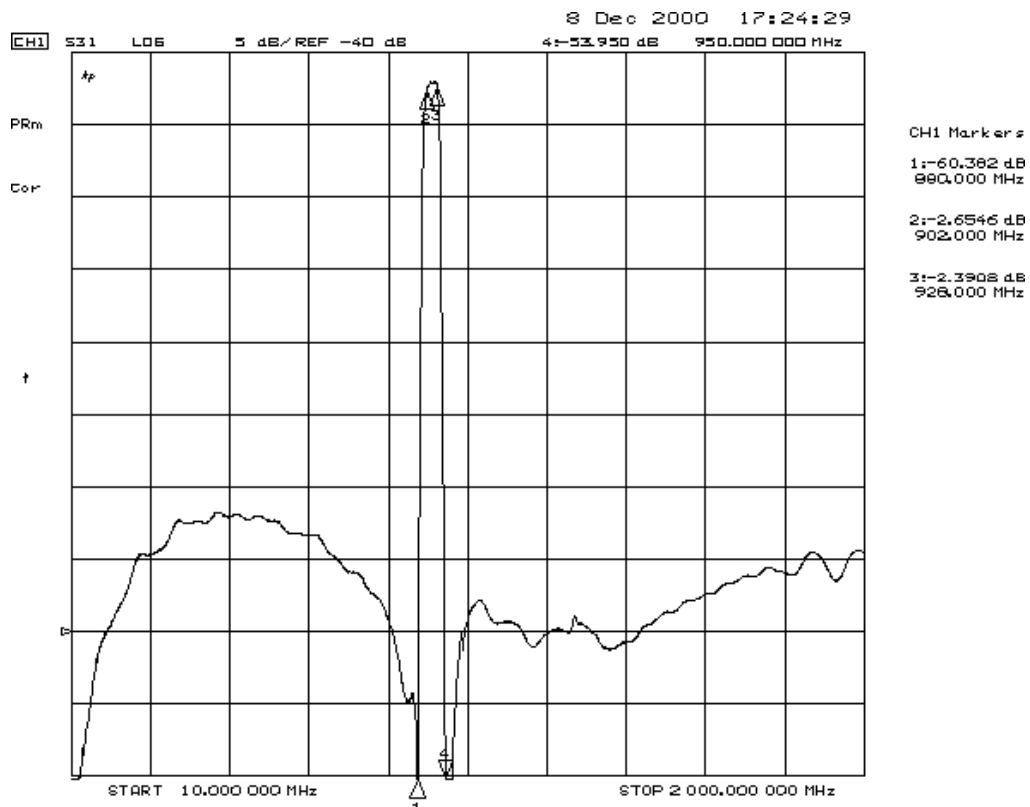
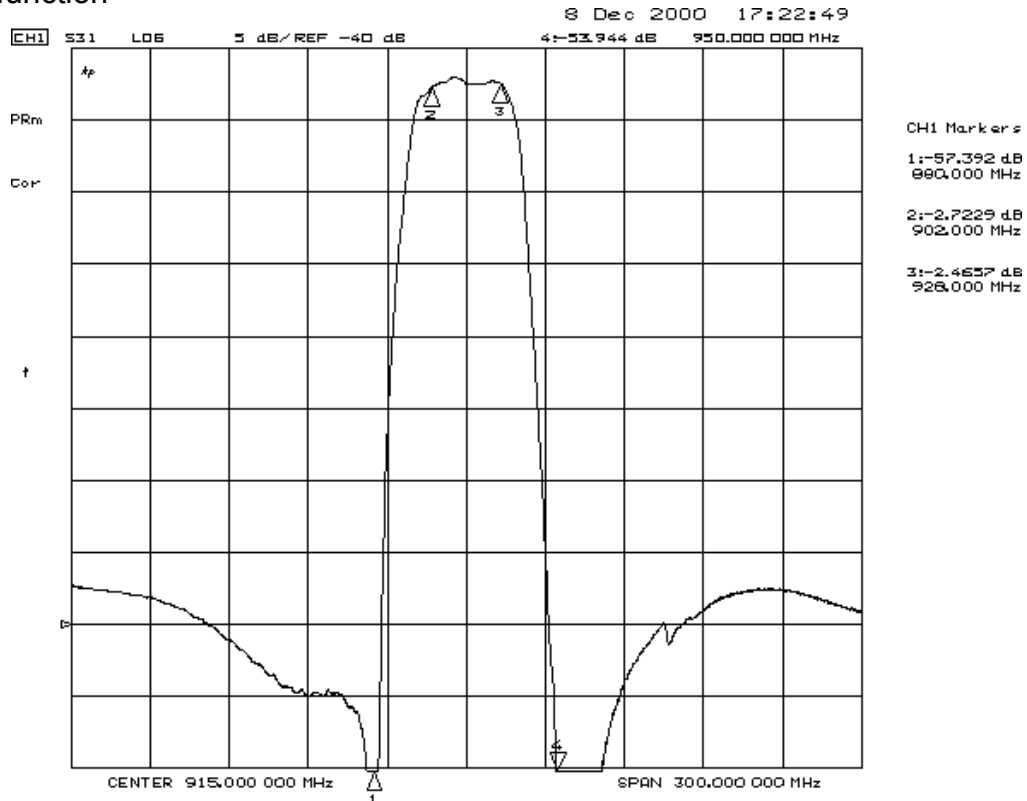

SAW Filter 915.0MHz for ISM900 (High Attenuation)
Part No: MA03704

Model: TA915FC
Rev No: 2

F. PACKING:

1. Reel Dimension

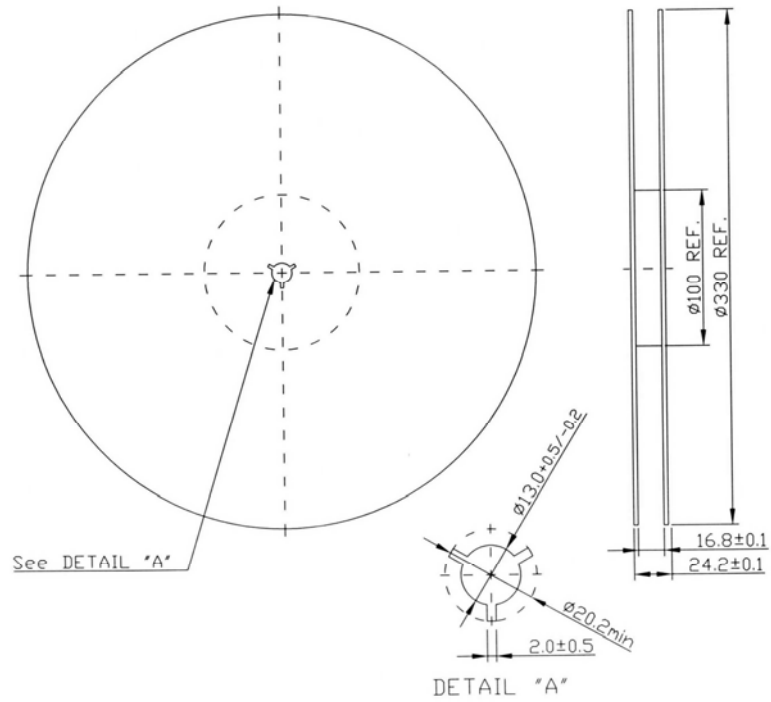

2. Tape Dimension

