

**P.C.B. LAYOUT**

**Specifications :**

- Voltage rating: 250V AC / DC
- Current rating: 5A AC / DC
- Withstanding voltage: 1000V AC/minute
- Temperature range: -25°C~+85°C
- Insulation resistance: ≥1000MΩ
- Contact resistance: ≤10mΩ
- After environmental testing: ≤20mΩ
- Mark "\*" Indicate Dimensions Need to Controlled In Emphasis

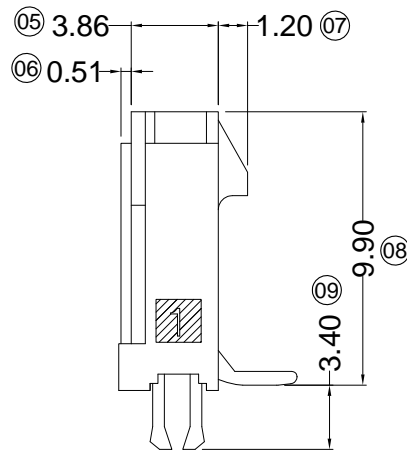
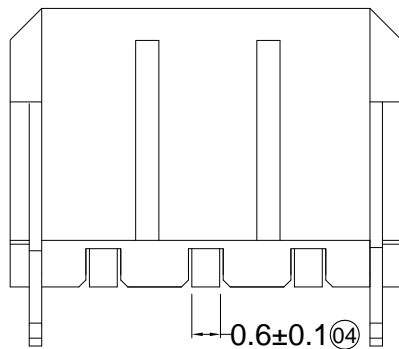

X3025 W V S- XX C-XX XX XX

- ① Series No.
- ② Category: W-wafer
- ③ Welding Board Angle: V-180°
- ④ Welding Way: S-SMT
- ⑤ Row No.-Pin No. XX-Single row
- ⑥ Special NO. C-The harpoon
- ⑦ Material: LP-LCP 94V-0 66-PA66 94V-0
- ⑧ Planting Category: V\*\* :All Gold-Plated G\*\* :Gold-Plated Contact \*01-Gold Flash ; \*02-2U" ; \*03-3U" ; \*05-5U" \*10-10U" ; \*15-15U" ; \*30-30U" ; \*50-50U" SN1-Bright tin plating 70U" SN1-Bright tin plating 120U"Min. ; SW-Fog Tin plating
- ⑨ Color: Blank-natural color

Poles	Dimensions (mm)		
	A	B	C
02	6.85	3.00	7.30
03	9.85	6.00	10.30
04	12.85	9.00	13.30
05	15.85	12.00	16.30
06	18.85	15.00	19.30
07	21.85	18.00	22.30
08	24.85	21.00	25.30
09	27.85	24.00	28.30
10	30.85	27.00	31.30
11	33.85	30.00	34.30
12	36.85	33.00	37.30

X3025WVS-XXC-LPSW	LCP UL 94V-0	Brass	Tin Plating Fog	Brass	Tin-Plated	X3025H
X3025WVS-XXC-66SN	PA66 UL 94V-0	Brass	Tin-Plated	Brass	Tin-Plated	X3025H
PART NO	Material	Material(Pin)	Finish(Pin)	Material (Solder Tabs)	Finish (Solder Tabs)	Mates With XKB Housing

For and on behalf of  
**XKB INDUSTRIAL PRECISION CO., LIMITED**  
 香港星坤工業精密有限公司

△ X	DESCRIPTION	DATE	REVISED	APPROVED	UNSPECIFIED TOLERANCES	DSND	DATE	SCALE: N/A	MODEL TYPE: X3025WVS-XXC-XXXX	
△ X						DWN	DATE	VIEW:	PART NO.:	
△ X						CHKD	DATE	UNIT: mm	3.00 mm Crimp Style Connectors	
MARK						APPD	DATE	SIZE: A4	DWG NO.:	
	REVISIONS					XKB INDUSTRIAL PRECISION CO., LIMITED			WEIGHT	SHEET
	Authorized Signature(s)								1.0g	1/1
									REVISION	
									A0	