

THIS IS A CONTROLLED DOCUMENT AND IS SUBJECT TO CHANGE
CONTACT ENGINEERING DEPARTMENT FOR LATEST REVISION

DWG. NO. 272-910-0630C

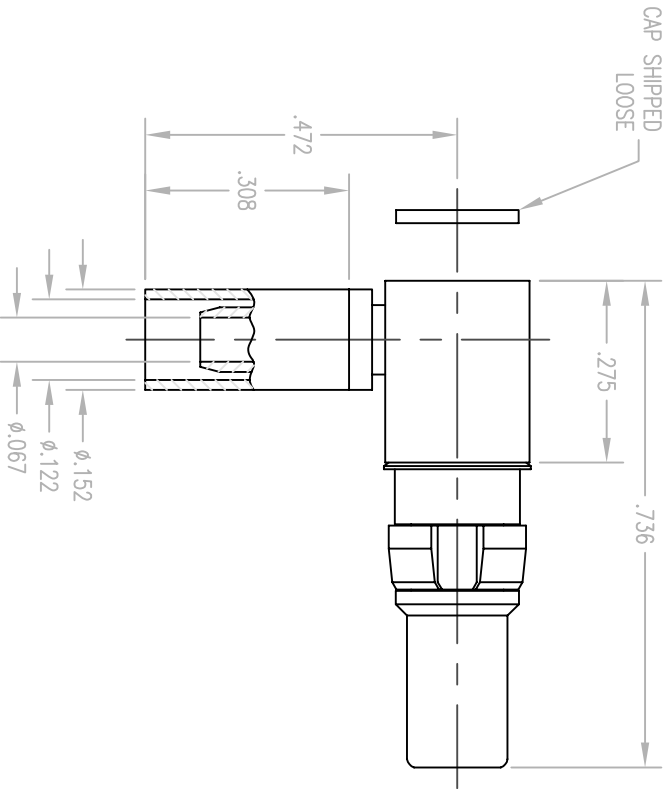

NOTES:

1. MATERIALS:
CENTER CONTACT: BERYLLIUM COPPER PER ASTM B196
CLIP RING AND SPRING WASHER: PHOSPHOR BRONZE PER ASTM B103
INSULATOR: TEFLON PER ASTM D1710
ALL OTHER METAL PARTS: BRASS PER ASTM B16
2. FINISH:
BODY AND CENTER CONTACT: .000015 MIN. GOLD PER MIL-G-45204 OVER
.000050 MIN. NICKEL PER QQ-N-290
CAP AND SPRING WASHER: .000005 MIN. GOLD PER MIL-G-45204 OVER
.000050 MIN. NICKEL PER QQ-N-290
3. ELECTRICAL:
FERRULE: TIN PER ASTM B545
IMPEDANCE: 75 OHMS
FREQUENCY RANGE: 0-2 GHz
4. FOR USE WITH RG-316 OR EQUIVALENT CABLE.
5. FOR CABLING PROCEDURES USE CAP 9-02 WITH THE TRIMMING DIMENSIONS SHOWN.

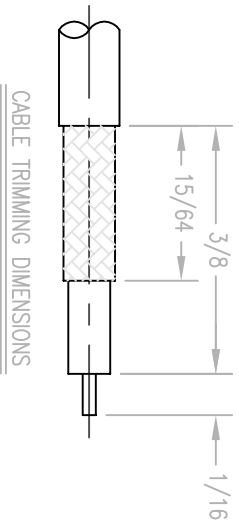

UNLESS OTHERWISE SPECIFIED

ALL DIMENSIONS ARE NOMINAL AND
FOR REFERENCE ONLY.
DIMENSIONS IN INCHES
DO NOT SCALE PRINT



RETCONN

A SUBSIDIARY OF SPM
199 W. BEAR ROAD
TORRINGTON, CT 06790
TEL (860) 498-1220 FAX (860) 498-3307

SALES DRAWING

TITLE

RDM 75 OHM RIGHT ANGLE PLUG

REV.	DESCRIPTION OF CHANGE	DATE	DRN	APPR	MATERIAL	FINISH	DRAWN	DATE	CHECKED	SCALE	FSQM	ODW/4
-	NPR 764	3/9/98	JED				JED	3/9/98		4:1		
REVISIONS												

THIS INFORMATION IS PROPRIETARY AND CONFIDENTIAL. IT IS DISCLOSED TO YOU ON
CONDITION NO FURTHER DISCLOSURE IS MADE TO OTHER THAN RETCONN PERSONNEL
WITHOUT WRITTEN AUTHORIZATION FROM RETCONN INC., TORRINGTON, CT.