

PLEASE CHECK WWW.MOLEX.COM FOR LATEST PART INFORMATION

Part Number: [0908580495](#)
Status: **Active**
Overview: [rast 5 connector system](#)
Description: 5.00mm (.197") Pitch Appli-Mate RAST 5 Header, Vertical, 2 Circuits, Silver Plating, Reference K03

Documents:

| | |
|---|--|
| 3D Model | Drawing (PDF) |
| Packaging Specification (PDF) | RoHS Certificate of Compliance (PDF) |

Agency Certification

| | |
|-----|---------|
| CSA | LR19980 |
| UL | E29179 |

General

| | |
|----------------|---|
| Product Family | PCB Headers |
| Series | 90858 |
| Application | Wire-to-Board |
| Overview | rast 5 connector system |
| Product Name | RAST 5 |

Physical

| | |
|--------------------------------|----------------|
| Breakaway | No |
| Circuits (Loaded) | 2 |
| Circuits (maximum) | 2 |
| Color - Resin | Natural |
| Durability (mating cycles max) | 10 |
| First Mate / Last Break | No |
| Flammability | 94V-0 |
| Glow-Wire Compliant | No |
| Guide to Mating Part | No |
| Keying to Mating Part | None |
| Lock to Mating Part | None |
| Material - Metal | Brass |
| Material - Plating Mating | Silver |
| Material - Plating Termination | Silver |
| Number of Rows | 1 |
| Orientation | Vertical |
| PC Tail Length (in) | 0.138 In |
| PC Tail Length (mm) | 3.50 mm |
| PCB Locator | Yes |
| PCB Retention | None |
| PCB Thickness Recommended (in) | 0.055 In |
| PCB Thickness Recommended (mm) | 1.40 mm |
| Packaging Type | Bag |
| Pitch - Mating Interface (in) | 0.197 In |
| Pitch - Mating Interface (mm) | 5.00 mm |
| Polarized to PCB | Yes |
| Shrouded | Fully |
| Stackable | Yes |
| Surface Mount Compatible (SMC) | No |
| Temperature Range - Operating | -20°C to +85°C |
| Termination Interface: Style | Through Hole |

Electrical

| | |
|-------------------------------|-----|
| Current - Maximum per Contact | 16A |
|-------------------------------|-----|

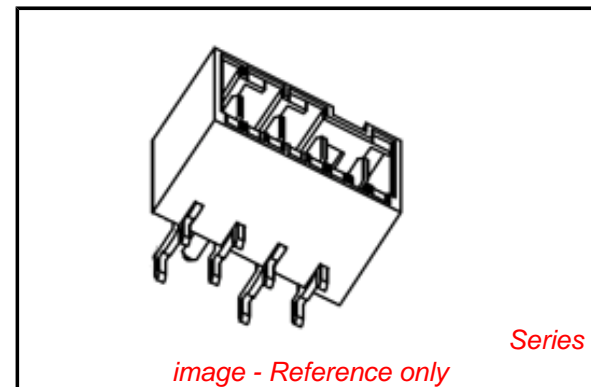

image - Reference only

EU RoHS

ELV and RoHS Compliant
REACH SVHC Contains SVHC: No
Halogen-Free Status
Not Reviewed

China RoHS



Need more information on product environmental compliance?

Email productcompliance@molex.com
 For a multiple part number RoHS Certificate of Compliance, [click here](#)

Please visit the [Contact Us](#) section for any non-product compliance questions.

Search Parts in this Series

[90858Series](#)

Mates With

Appli-Mate 5.0 IDT Connector System
 Female Receptacle [90835](#) , [90833](#)

Voltage - Maximum

250V

Material Info

Reference - Drawing Numbers

Packaging Specification

PK-90858-001

Sales Drawing

SD-90858-001

This document was generated on 06/08/2010

PLEASE CHECK WWW.MOLEX.COM FOR LATEST PART INFORMATION

13 12 11 10 9 8 7 6 5 4 3 2 1

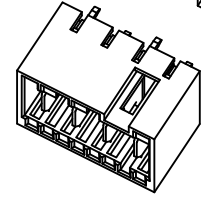
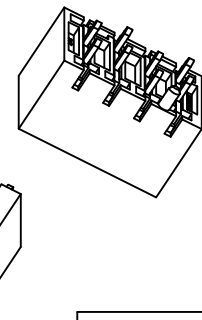
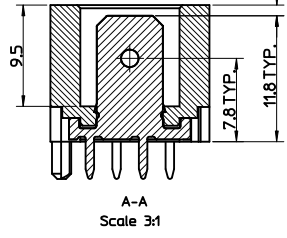
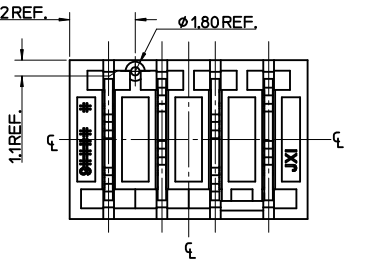
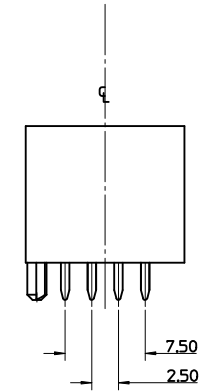
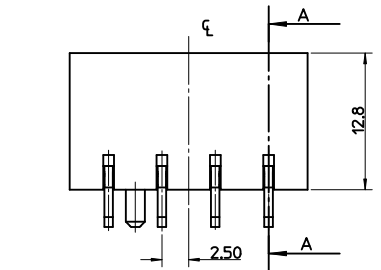
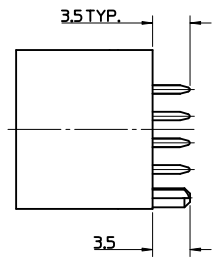
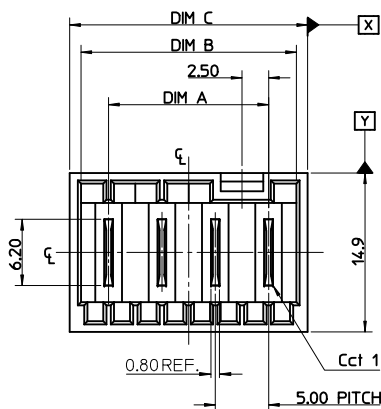

HOLES ON SOME TOOLED VERSIONS

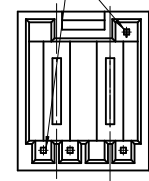

| CCT | DIM A | DIM B | DIM C | TOL |
|-----|-------|-------|-------|---------|
| 2 | 5.00 | 10.20 | 12.30 | |
| 3 | 10.00 | 15.20 | 17.30 | |
| 4 | 15.00 | 20.20 | 22.30 | |
| 5 | 20.00 | 25.20 | 27.30 | |
| 6 | 25.00 | 30.20 | 32.30 | +/-0.30 |
| 7 | 30.00 | 35.20 | 37.30 | |
| 8 | 35.00 | 40.20 | 42.30 | |
| 9 | 40.00 | 45.20 | 47.30 | |
| 10 | 45.00 | 50.20 | 52.30 | |
| 11 | 50.00 | 55.20 | 57.30 | |
| 12 | 55.00 | 60.20 | 62.30 | |

- NOTES:
- MATERIALS
 HOUSING: 30% GLASS-FILLED PBT, UL94 V-0
 TERMINAL: BRASS 0.80REF. THICK
 PLATING: OPTIONAL (SEE CHARTS SHEETS 2-9)
 5µm TIN OVER
 2.5µm NICKEL ALLOVER
 SELECTIVE SILVER
 2µm MIN SILVER
 2.5µm NICKEL ALLOVER
 - PRODUCT CONFORMS TO SPECIFICATION PS-99020-0037
 - MATES WITH MOLEX 91338, 90833, 90835, 91777, 91778 & 91779
 - PARTS PACKAGED LOOSE IN PLASTIC BAGS
 - PLATED THRU HOLE
 - NON-PLATED THRU HOLE
 - RECOMMENDED PCB THICKNESS: 1.4±0.1mm
 - PCB VIEW IS FROM SOLDER SIDE

RECOMMENDED PCB LAYOUT

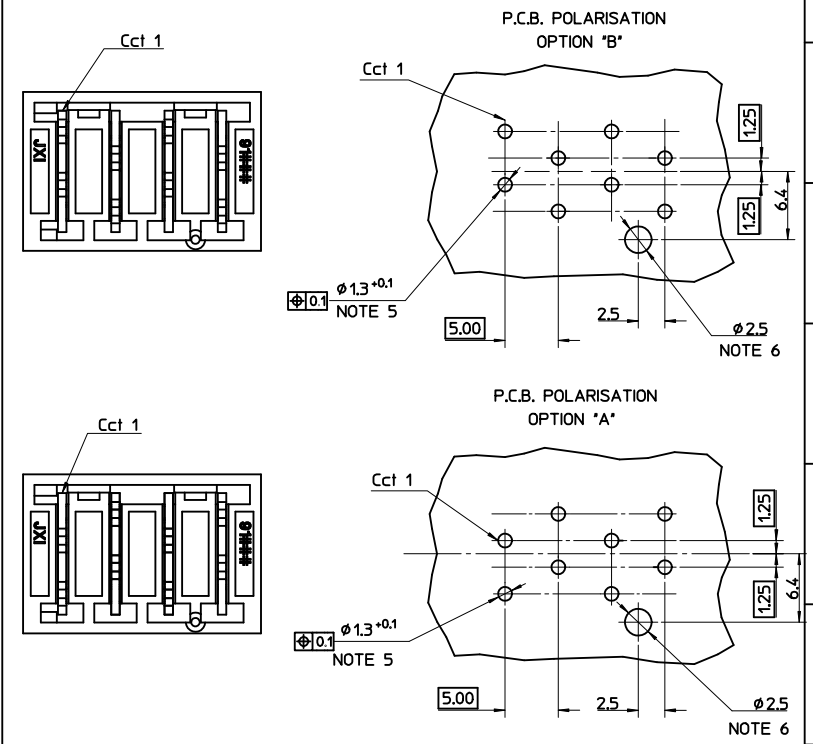

| | | | | | | | |
|--|--|---|---|----------------------------|--------------------------|------------------------|------------------------|
| MOULD PROCESS CHANGE EC NO: E2010-0370 DRAWN: BRUTTLE 2010/05/13 CHKD: IDENEY 2004/05/27 APPR: BMAGUIRE 2010/06/08 | QUALITY SYMBOLS ∇=0 ∇=0 | GENERAL TOLERANCES (UNLESS SPECIFIED) | | DIMENSION STYLE MM ONLY | SCALE 1:1 | DESIGN UNITS METRIC | THIRD ANGLE PROJECTION |
| | | 4 PLACES ± --- ± --- 3 PLACES ± 0.1 ± --- 2 PLACES ± 0.2 ± --- 1 PLACE ± 0.2 ± --- | DRAWN BY NMCNAMAR DATE 2004/05/26 | TITLE RAST 5 VERT HDR | MOLEX MOLEX INCORPORATED | | |
| MOULD PROCESS CHANGE EC NO: E2010-0370 DRAWN: BRUTTLE 2010/05/13 CHKD: IDENEY 2004/05/27 APPR: BMAGUIRE 2010/06/08 | DRAFT WHERE APPLICABLE MUST REMAIN WITHIN DIMENSIONS | MATERIAL NO. SD-SHEETS 2-7 SD-90858-001 | APPROVED BY BMAGUIRE DATE 2004/05/28 | SHEET NO. 1 OF 7 | | | |

12 11 10 9 8 7 6 5 4 3 2 1

| 2 CIRCUIT | | SEE CODE DESIGNATION TABLE FOR NUMBERING FORMAT WHEN ADDING NEW PART NUMBERS | | | | | | P.C.B. POLARISATION OPTION |
|-------------------|---------|---|--------------------------|-------------------|------------------------------|-----|----------------------|----------------------------------|
| PART NO. (TIN) | COLOUR | UNBLOCKED POSITION KEYS | UNBLOCKED CODING KEYS | LATCH POSITION | CONFIGURATION (SEE NOTES) | REF | PART NO. (SILVER) | |
| 90858-0003 | NATURAL | 1b 2a | 01c d20 | 1/2 | | K01 | 90858-0499 | A |
| 90858-0004 | NATURAL | 1a 2b | 01c | 1/2 | | K02 | 90858-0482 | A |
| 90858-0007 | NATURAL | 1b 2b | 01c | 1/2 | | K09 | 90858-0497 | A |
| 90858-0018 | NATURAL | 2a | 01c, d20 | 1/2 | | K03 | 90858-0495 | A |
| 90858-0019 | NATURAL | 1a 2b | d20 | 1/2 | | K05 | 90858-0478 | A |
| 90858-0021 | NATURAL | 1b | 01c, d20 | 1/2 | | K16 | 90858-0492 | A |
| 90858-0022 | NATURAL | 1a 2b | NONE | 1/2 | | K06 | 90858-0491 | A |
| 90858-0027 | NATURAL | 2b | NONE | 1/2 | | K11 | 90858-0487 | A |
| 90858-0029 | NATURAL | 1a 1b | d20 | 1/2 | | K13 | 90858-0486 | A |
| 90858-0030 | NATURAL | 2a 2b | NONE | 1/2 | | K31 | 90858-0485 | A |
| 90858-0032 | NATURAL | 2b | d20 | 1/2 | | K38 | 90858-0484 | A |
| 90858-0047 | NATURAL | 1a 2a | 01c d20 | 1/2 | | K44 | 90858-0483 | A |
| 90858-0055 | NATURAL | 1a 1b | NONE | 1/2 | | K40 | 90858-0480 | A |
| 90858-0020 | NATURAL | 1a 1b | 01c | 1/2 | | K04 | 90858-0475 | A |
| 90858-0054 | NATURAL | 2b | 01c d20 | 1/2 | | K15 | 90858-0476 | A |
| 90858-0057 | NATURAL | 1a | 01c d20 | 1/2 | | K12 | 90858-0477 | A |
| 90858-0058 | NATURAL | 1a 2a | 01c | 1/2 | | K10 | 90858-0472 | A |
| 90858-0059 | NATURAL | ALL | d20 | 1/2 | | K34 | 90858-0474 | A |
| 90858-0060 | NATURAL | 1b 2a 2b | d20 | 1/2 | | K07 | 90858-0473 | A |
| 90858-0061 | NATURAL | 1b 2a | 01c d20 | 1/2 | | K01 | 90858-0471 | B |
| | | | | | | | | |
| | | | | | | | | |
| | | | | | | | | |

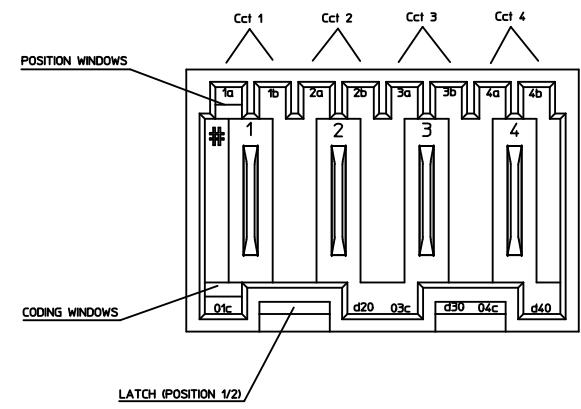

KEYING, CODING & LATCH POSITION
(4CCT EXAMPLE SHOWN)
VIEW INMATING DIRECTION

| | | | | | | | |
|---|--|---|---|------------------------------|---------------------|--|--------------------|
| SEE SHEET 1 EC NO: E2010-0370 DRN:BRUTTE 2010/05/13 CHKD:JDENNEY 2004/05/27 APPR:BMAGUIRE 2010/06/08 | QUALITY SYMBOLS | GENERAL TOLERANCES (UNLESS SPECIFIED) | DIMENSION STYLE | SCALE | DESIGN UNITS | THIRD ANGLE PROJECTION | |
| | $\nabla=0$ $\nabla=0$ | mm INCH 4 PLACES ± --- ± --- 3 PLACES ± --- ± --- 2 PLACES ± 0.1 ± --- 1 PLACE ± 0.2 ± --- ANGULAR ± 2 ° | MM ONLY DRAWN BY DATE NMCNAR 2004/05/26 CHECKED BY DATE JDENNEY 2004/05/27 APPROVED BY DATE BMAGUIRE 2004/05/28 | 1:1 | METRIC | <input checked="" type="checkbox"/> THIRD ANGLE PROJECTION | |
| | DRAFT WHERE APPLICABLE MUST REMAIN WITHIN DIMENSIONS | SEE CHART | MATERIAL NO. SD-90858-001 | DOCUMENT NO. SD-90858-001 | SHEET NO. 2 OF 7 | TITLE RAST 5 VERT HDR | MOLEX INCORPORATED |
| | | THIS DRAWING CONTAINS INFORMATION THAT IS PROPRIETARY TO MOLEX INCORPORATED AND SHOULD NOT BE USED WITHOUT WRITTEN PERMISSION | | | | | |

3 CIRCUIT

SEE CODE DESIGNATION TABLE FOR NUMBERING
FORMAT WHEN ADDING NEW PART NUMBERS

| PART NO. (TIN) | COLOUR | UNBLOCKED POSITION KEYS | UNBLOCKED CODING KEYS | LATCH POSITION | CONFIGURATION (SEE NOTES) | REF | PART NO. (SILVER) | P.C.B. POLARISATION OPTION |
|-------------------|---------|----------------------------|--------------------------|-------------------|------------------------------|-----|----------------------|----------------------------------|
| 90858-0502 | NATURAL | 1b | 01c, d20 | 1/2 | | K01 | 90858-1249 | A |
| 90858-0508 | NATURAL | 1a | 03c | 1/2 | | K04 | 90858-1248 | A |
| 90858-0511 | NATURAL | 1a 1b | d30 | 1/2 | | K05 | 90858-1247 | A |
| 90858-0512 | NATURAL | 1a 3b | 01c | 1/2 | | K06 | 90858-1246 | A |
| 90858-0513 | NATURAL | 1b | d20 03c | 1/2 | | K09 | 90858-1245 | A |
| 90858-0524 | NATURAL | 1b 2a 2b | d30 | 1/2 | | K33 | 90858-1244 | A |
| 90858-0525 | NATURAL | 2b | d20 | 1/2 | | K56 | 90858-1243 | A |
| 90858-0528 | NATURAL | ALL | d10 d30 | 2/3 | | K38 | 90858-1242 | A |
| 90858-0527 | NATURAL | ALL | d20 | 1/2 | | K40 | 90858-1240 | A |
| 90858-0526 | NATURAL | 2b 3b | d10 02c | 2/3 | | K02 | 90858-1241 | A |
| 90858-0529 | NATURAL | 1b | 01c d20 | 1/2 | | | 90858-1239 | A |
| 90858-0530 | NATURAL | 3b | d10, d30 | 2/3 | | | 90858-1238 | A |
| 90858-0531 | NATURAL | 3b | 01c, d30 | 2/3 | | | 90858-1237 | A |
| 90858-0532 | NATURAL | 3b | d10, 02c | 2/3 | | | 90858-1236 | A |
| | | | | | | | | |
| | | | | | | | | |

4 CIRCUIT

SEE CODE DESIGNATION TABLE FOR NUMBERING
FORMAT WHEN ADDING NEW PART NUMBERS

| PART NO. (TIN) | COLOUR | UNBLOCKED POSITION KEYS | UNBLOCKED CODING KEYS | LATCH POSITION | CONFIGURATION (SEE NOTES) | REF | PART NO. (SILVER) | P.C.B. POLARISATION OPTION |
|-------------------|---------|----------------------------|--------------------------|-------------------|------------------------------|-----|----------------------|----------------------------------|
| 90858-1254 | NATURAL | 1b | 03c d40 | 1/2 3/4 | | K01 | 90858-1999 | A |
| 90858-1264 | NATURAL | 1a 4b | d40 | 1/2 3/4 | | K03 | 90858-1998 | A |
| 90858-1265 | NATURAL | 2a 4b | d20 | 1/2 3/4 | | K07 | 90858-1996 | A |
| 90858-1267 | NATURAL | 1b 2a 3a 4b | 01c d40 | 1/2 3/4 | | K37 | 90858-1994 | A |
| 90858-1270 | NATURAL | 1a 2b 4b | 01c 03c d40 | 1/2 3/4 | | K44 | 90858-1993 | A |
| 90858-1274 | NATURAL | 1a 3a 3b | 01c d20 d40 | 1/2 3/4 | | K32 | 90858-1992 | A |
| 90858-1275 | NATURAL | 1b 2a 4b | 01c d20 03c | 1/2 3/4 | | K61 | 90858-1991 | A |
| 90858-1278 | NATURAL | 1a 3a | d40 | 1/2 3/4 | | K06 | 90858-1987 | A |
| 90858-1280 | NATURAL | 1a 2b 3b 4a | 01c 03c d40 | 1/2 3/4 | | K65 | 90858-1988 | A |
| 90858-1281 | NATURAL | 2a 4b | d20 03c | 1/2 3/4 | | K30 | 90858-1986 | A |
| 90858-1282 | NATURAL | 3b | d30 | 2/3 | | K04 | 90858-1985 | A |
| 90858-1283 | NATURAL | 1b 2a 4b | 01c d20 03c d40 | 1/2 3/4 | | N/A | 90858-1984 | A |
| 90858-1284 | NATURAL | 2a 3a 3b 4b | 01c d20 03c d40 | 1/2 3/4 | | N/A | 90858-1983 | A |
| | | | | | | | | |
| | | | | | | | | |
| | | | | | | | | |

| | | | | | | | | |
|--|-------------------------|---|--|--|--|---|------------------------|----------------------------|
| SEE SHEET 1 EEC NO: E2010-0370 DRAWN BY: DRWNBRUTLE CHECKED BY: CHKD.DENNEHY APPROVED BY: APPR.BMAGUIRE 2010/05/13 2004/05/27 2010/06/08 | QUALITY SYMBOLS | GENERAL TOLERANCES (UNLESS SPECIFIED) mm INCH 4 PLACES ± --- ± --- 3 PLACES ± --- ± --- 2 PLACES ± 0.1 ± --- 1 PLACE ± 0.2 ± --- ANGULAR ± 2 ° | | DIMENSION STYLE MM ONLY DRAWN BY: NMCNAMAR DATE: 2004/05/26 CHECKED BY: JDENNEHY DATE: 2004/05/27 APPROVED BY: BMAGUIRE DATE: 2004/05/28 | | SCALE 1:1 | DESIGN UNITS METRIC | THIRD ANGLE PROJECTION |
| | | DRAFT WHERE APPLICABLE MUST REMAIN WITHIN DIMENSIONS | | SEE CHART | | MOLEX INCORPORATED DOCUMENT NO. SD-90858-001 | | |
| | | | | MATERIAL NO. | | SHEET NO. 3 OF 7 | | |
| | | THIS DRAWING CONTAINS INFORMATION THAT IS PROPRIETARY TO MOLEX INCORPORATED AND SHOULD NOT BE USED WITHOUT WRITTEN PERMISSION | | | | | | |

5 CIRCUIT

SEE CODE DESIGNATION TABLE FOR NUMBERING
FORMAT WHEN ADDING NEW PART NUMBERS

| PART NO. (TIN) | COLOUR | UNLOCKED POSITION KEYS | UNLOCKED CODING KEYS | LATCH POSITION | CONFIGURATION (SEE NOTES) | REF | PART NO. (SILVER) | P.C.B. POLARISATION OPTION |
|-------------------|---------|---------------------------|-------------------------|-------------------|------------------------------|-----|----------------------|----------------------------------|
| 90858-2000 | NATURAL | 1a 5b | 01c d30 | 1/2 2/3 | | K01 | 90858-2749 | A |
| 90858-2001 | NATURAL | 1a 3a | 01c d30 | 1/2 4/5 | | K30 | 90858-2748 | A |
| 90858-2002 | NATURAL | 1a 5b | 01c d20 03c d50 | 1/2 3/4 | | K31 | 90858-2747 | A |
| 90858-2003 | NATURAL | 1b 2a 3b 5a | 01c 03c | 1/2 3/4 | | K35 | 90858-2746 | A |
| 90858-2004 | NATURAL | 1a 2a 2b 4b 5b | 01c d30 04c d50 | 1/2 2/3 4/5 | | K36 | 90858-2745 | A |
| 90858-2006 | NATURAL | 2a | 01c d50 | 2/3 4/5 | | K43 | 90858-2742 | A |
| 90858-2012 | NATURAL | 2a 4b | 01c d20 d40 | 1/2 3/4 | | K44 | 90858-2743 | A |
| 90858-2013 | NATURAL | 2b | d20 | 1/2 4/5 | | K02 | 90858-2741 | A |
| 90858-2014 | NATURAL | 4b 5a | 01c d30 04c d50 | 1/2 4/5 | | K45 | 90858-2740 | A |
| 90858-2015 | NATURAL | NONE | 01c d40 | 1/2 3/4 | | K46 | 90858-2739 | A |
| 90858-2017 | NATURAL | 1a 4a | d30 | 1/2 4/5 | | K04 | 90858-2737 | A |
| 90858-2024 | NATURAL | 1a 5b | d20 d40 | 1/2 3/4 | | K77 | 90858-2732 | A |
| 90858-2025 | NATURAL | 2b | d20 d50 | 1/2 3/4 | | K95 | 90858-2733 | A |
| 90858-2026 | NATURAL | 1a 5b | 01c d20 03c d50 | 1/2 3/4 | | | 90858-2734 | A |
| 90858-2027 | NATURAL | 1a 3a 4b 5a | 03c 04c | 1/2 4/5 | | K73 | 90858-2735 | A |
| 90858-2028 | NATURAL | 2b | d20 | 1/2 4/5 | | | 90858-2731 | A |
| 90858-2029 | NATURAL | 1b 2a 4a | 01c 04c d50 | 1/2 4/5 | | K51 | 90858-2730 | A |
| 90858-2030 | NATURAL | 2b 3b 4a | 01c d20 d40 | 1/2 3/4 | | K52 | 90858-2729 | A |
| 90858-2031 | NATURAL | 1a 5b | 01c d20 03c d50 | 1/2 4/5 | | K86 | 90858-2728 | A |
| 90858-2032 | NATURAL | 1a 1b 4a | d30 04c d50 | 1/2 4/5 | | K64 | 90858-2727 | A |
| 90858-2033 | NATURAL | 1a 5b | 01c d20 03c d50 | 1/2 3/4 | | | 90858-2726 | B |

6 CIRCUIT

SEE CODE DESIGNATION TABLE FOR NUMBERING
FORMAT WHEN ADDING NEW PART NUMBERS

| PART NO. (TIN) | COLOUR | UNLOCKED POSITION KEYS | UNLOCKED CODING KEYS | LATCH POSITION | CONFIGURATION (SEE NOTES) | REF | PART NO. (SILVER) | P.C.B. POLARISATION OPTION |
|-------------------|---------|---------------------------|-------------------------|-------------------|------------------------------|-----|----------------------|----------------------------------|
| 90858-2753 | NATURAL | 1b | 03c d60 | 1/2 4/5 | | K01 | 90858-3499 | A |
| 90858-2754 | NATURAL | 1a 3b 4b | 01c d50 06c | 1/2 4/5 | | K30 | 90858-3498 | A |
| 90858-2755 | NATURAL | 1a 1b 2b 3a 3b 4b | d30 04c d50 | 1/2 2/3 4/5 | | K37 | 90858-3497 | A |
| 90858-2756 | NATURAL | 1a 1b 4a 4b | d10 d50 | 2/3 4/5 | | K39 | 90858-3496 | A |
| 90858-2757 | NATURAL | 2a 4b 5a 6b | d20 03c 05c | 1/2 3/4 5/6 | | K42 | 90858-3495 | A |
| 90858-2758 | NATURAL | 1a 2b 3a 3b 5b 6b | 01c d40 d60 | 1/2 3/4 5/6 | | K43 | 90858-3494 | A |
| 90858-2759 | NATURAL | 1b 2a 3a 4b 5a 5b 6b | 01c 03c d60 | 1/2 3/4 5/6 | | K44 | 90858-3493 | A |
| 90858-2761 | NATURAL | 2b | d20 d60 | 1/2 5/6 | | K46 | 90858-3492 | A |
| 90858-2762 | NATURAL | 2b 3b 4a | 01c d50 06c | 1/2 4/5 | | K36 | 90858-3491 | A |
| 90858-2768 | NATURAL | 1b 4b | d20 03c d50 06c | 1/2 4/5 | | K58 | 90858-3486 | A |
| 90858-2769 | NATURAL | 1a 2b 3b 4a 6b | 01c 03c d40 05c d60 | 1/2 3/4 5/6 | | K59 | 90858-3485 | A |
| 90858-2770 | NATURAL | 1a 2b 4a 6b | 01c d40 | 1/2 3/4 5/6 | | K62 | 90858-3484 | A |
| 90858-2771 | NATURAL | 1b 6b | d40 | 1/2 5/6 | | K04 | 90858-3483 | A |
| 90858-2772 | NATURAL | 1b 2a 3a 4b 5a 5b 6b | 01c d60 | 2/3 5/6 | | K15 | 90858-3482 | A |
| | | | | | | | | |
| | | | | | | | | |

| | | | | | | | |
|--|-------------------------------|--|---------------------------------------|---|--------------------------|------------------------------|---|
| SEE SHEET 1 EC NO: E2010-0370 DRW:BRUTTE 2010/05/13 CHKD:JDENNEY 2004/05/27 APPR:BMAGUIRE 2010/06/08 | QUALITY SYMBOLS ▽=0 ▽=0 | GENERAL TOLERANCES (UNLESS SPECIFIED) mm INCH 4 PLACES ± --- ± --- 3 PLACES ± --- ± --- 2 PLACES ± 0.1 ± --- 1 PLACE ± 0.2 ± --- ANGULAR ± 2 ° | DIMENSION STYLE MM ONLY | SCALE 1:1 | DESIGN UNITS METRIC | THIRD ANGLE PROJECTION | |
| | | DRAWN BY DATE NMCNAMAR 2004/05/26 | CHECKED BY DATE JDENNEY 2004/05/27 | APPROVED BY DATE BMAGUIRE 2004/05/28 | TITLE RAST 5 VERT HDR | MOLEX INCORPORATED | SHEET NO. 4 OF 7 |
| | | DRAFT WHERE APPLICABLE MUST REMAIN WITHIN DIMENSIONS | | | SEE CHART | DOCUMENT NO. SD-90858-001 | THIS DRAWING CONTAINS INFORMATION THAT IS PROPRIETARY TO MOLEX INCORPORATED AND SHOULD NOT BE USED WITHOUT WRITTEN PERMISSION |
| | | SIZE 1 | | | | | |

9 CIRCUIT

| SEE CODE DESIGNATION TABLE FOR NUMBERING FORMAT WHEN ADDING NEW PART NUMBERS | | | | | | | P.C.B. POLARISATION OPTION | |
|---|---------|----------------------------------|--------------------------|------------------------|------------------------------|-----|----------------------------------|---|
| PART NO. (TIN) | COLOUR | UNBLOCKED POSITION KEYS | UNBLOCKED CODING KEYS | LATCH POSITION | CONFIGURATION (SEE NOTES) | REF | | |
| 90858-5002 | NATURAL | 1a 2a 2b 3a 3b 6a 7a 8b 9b | d20 03c d40 d50 d90 | 1/2 3/4 6/7 7/8 8/9 | | K30 | 90858-5997 | A |
| 90858-5003 | NATURAL | 1b 2a 3b 5a 6a 7b 8a 8b | 01c 03c d70 08c | 1/2 3/4 6/7 8/9 | | K31 | 90858-5996 | A |
| 90858-5004 | NATURAL | 1b 2a 3a 5a 6a 7b 8b | 01c 03c d70 08c d90 | 1/2 3/4 6/7 8/9 | | K32 | 90858-5995 | A |
| 90858-5005 | NATURAL | 1a 1b 3a 4b 5a 6b 7a | 01c d40 09c | 1/2 3/4 5/6 7/8 | | K37 | 90858-5994 | A |
| 90858-5006 | NATURAL | 1b 5a 8a 9a | 03c d40 d60 08c | 1/2 3/4 5/6 8/9 | | K38 | 90858-5993 | A |
| 90858-5007 | NATURAL | 2a 4b 5a 6b 7a 9a | d20 05c 07c | 1/2 3/4 5/6 7/8 | | K39 | 90858-5992 | A |
| 90858-5009 | NATURAL | 5b | d30 d70 | 1/2 6/7 | | K04 | 90858-5989 | A |
| 90858-5012 | NATURAL | 2b 3b 4a 5a 6b | d10 02c 04c 08c d90 | 2/3 4/5 6/7 8/9 | | K40 | 90858-5988 | A |
| 90858-5011 | NATURAL | 2b 5a | d80 | 2/3 7/8 | | K03 | 90858-5987 | A |
| 90858-5010 | NATURAL | 2b 3b 4b 6a | 01c d20 d40 05c d90 | 1/2 3/4 6/7 8/9 | | K49 | 90858-5986 | A |
| 90858-5013 | NATURAL | 1b 2a 4b 5a 8b 9b | 01c d20 d70 08c | 1/2 4/5 6/7 8/9 | | K58 | 90858-5985 | A |
| | | | | | | | | |
| | | | | | | | | |
| | | | | | | | | |
| | | | | | | | | |
| | | | | | | | | |

10 CIRCUIT

| SEE CODE DESIGNATION TABLE FOR NUMBERING FORMAT WHEN ADDING NEW PART NUMBERS | | | | | | | P.C.B. POLARISATION OPTION | |
|---|---------|--|-----------------------------------|-------------------------|------------------------------|-----|----------------------------------|---|
| PART NO. (TIN) | COLOUR | UNBLOCKED POSITION KEYS | UNBLOCKED CODING KEYS | LATCH POSITION | CONFIGURATION (SEE NOTES) | REF | | |
| 90858-6002 | NATURAL | 2a 3b 6a 9a | 03c d80 | 1/2 4/5 6/7 9/10 | | K30 | 90858-6997 | A |
| 90858-6003 | NATURAL | 1a 3b 7b 9b | 01c d20 d40 05c 07c | 1/2 3/4 5/6 7/8 9/10 | | K35 | 90858-6996 | A |
| 90858-6009 | NATURAL | 1b 2a 2b 4a 5b 6a 8a 9a 10a | d30 04c 06c 09c | 1/2 4/5 6/7 9/10 | | K41 | 90858-6988 | A |
| 90858-6010 | NATURAL | 1a 3b 4b 8a 10a 10b | 01c d50 06c 07c d80 09c | 1/2 4/5 7/8 9/10 | | K42 | 90858-6987 | A |
| 90858-6012 | NATURAL | 2a 4b 8a 10a | d20 05c d70 08c | 1/2 3/4 5/6 8/9 | | K44 | 90858-6986 | A |
| 90858-6015 | NATURAL | 1b 2a 3a 4b 5b 9a | 01c d40 d60 07c 09c d100 | 1/2 3/4 5/6 7/8 9/10 | | K48 | 90858-6983 | A |
| 90858-6016 | NATURAL | 1a 4b 6b 9a | 03c 04c d50 06c d70 08c d90 | 1/2 4/5 6/7 8/9 | | K36 | 90858-6982 | A |
| 90858-6021 | NATURAL | 1a 3b 7b 8a | 01c d20 d40 05c d100 | 1/2 3/4 5/6 7/8 9/10 | | K33 | 90858-6977 | A |
| 90858-6022 | NATURAL | 10a | d20 08c | 1/2 9/10 | | K56 | 90858-6976 | A |
| 90858-6023 | NATURAL | 1b 3b 5b 9a | 01c d60 07c 09c d100 | 1/2 3/4 5/6 7/8 9/10 | | K36 | 90858-6975 | A |
| 90858-6024 | NATURAL | 1b 2b 4a 7a 9a 9b | d20 d30 d50 06c d70 d80 | 1/2 4/5 6/7 9/10 | | K43 | 90858-6974 | A |
| 90858-6025 | NATURAL | 1a 2a 2b 3a 4a 4b 5a 6a 6b 7a 8a 8b 9a 10a 10b | NONE | 1/2 3/4 5/6 7/8 9/10 | | K45 | 90858-6973 | A |
| 90858-6026 | NATURAL | 2a 2b 3a 4a 5a 9a 10a | d20 d40 07c d70 08c d100 | 1/2 3/4 5/6 8/9 | | K46 | 90858-6972 | A |
| 90858-6027 | NATURAL | 1b 2a 3a 4b 6a 7a 8a 8b | 01c d40 d60 d80 | 1/2 3/4 5/6 9/10 | | K49 | 90858-6971 | A |
| 90858-6028 | NATURAL | 1b 5a 8b 9a 10b | 03c d40 d80 09c | 1/2 3/4 5/6 7/8 9/10 | | K50 | 90858-6970 | A |
| 90858-6029 | NATURAL | 1b 3a 4a 4b 6b 9a 9b | 01c d50 06c d70 09c | 1/2 4/5 6/7 9/10 | | K51 | 90858-6969 | A |
| 90858-6030 | NATURAL | 1b 4a 7a 9a | 01c d20 06c d80 09c | 1/2 4/5 7/8 9/10 | | K52 | 90858-6968 | A |

| | | | | | | | | |
|---|-------------------------------|--|---------------------------------------|---|------------------------|------------------------------|---------------------|--|
| SEE SHEET 1 EC NO: E2010-0370 DRAWN BY: DRW:BRUTTE CHKD: JDENNEY APPR: BMAGUIRE 2010/05/13 2004/05/27 2010/06/08 | QUALITY SYMBOLS ∇=0 ∇=0 | GENERAL TOLERANCES (UNLESS SPECIFIED) mm INCH 4 PLACES ± --- ± --- 3 PLACES ± --- ± --- 2 PLACES ± 0.1 ± --- 1 PLACE ± 0.2 ± --- ANGULAR ± 2 ° | DIMENSION STYLE MM ONLY | SCALE 1:1 | DESIGN UNITS METRIC | THIRD ANGLE PROJECTION | | |
| | | DRAWN BY DATE NMCNAMAR 2004/05/26 | CHECKED BY DATE JDENNEY 2004/05/27 | APPROVED BY DATE BMAGUIRE 2004/05/28 | MATERIAL NO. | DOCUMENT NO. SD-90858-001 | SHEET NO. 6 OF 7 | |
| | | DRAFT WHERE APPLICABLE MUST REMAIN WITHIN DIMENSIONS | | | SEE CHART | MOLEX INCORPORATED | | |
| | | THIS DRAWING CONTAINS INFORMATION THAT IS PROPRIETARY TO MOLEX INCORPORATED AND SHOULD NOT BE USED WITHOUT WRITTEN PERMISSION | | | | | | |

