

NOTES:
 Rated Current: 2.0AMP.
 Contact Resistance: 20mΩ Max.
 Withstand Voltage: 500V AC/DC
 Insulation Resistance: 1000MΩ Min.
 Operation Temperature: -40℃ to +125℃(GOLD)
 -40℃ to +105℃(TIN) $\Delta\Delta$

Contact Material: Brass
 Contact Plating: Au or Sn Over Ni
 Insulator Material: PA9T+33%G.F UL94V-0 BK

Recommended P.C.B Layout (Top Side)
 (PCB BOARD TOLERANCE ±0.05)

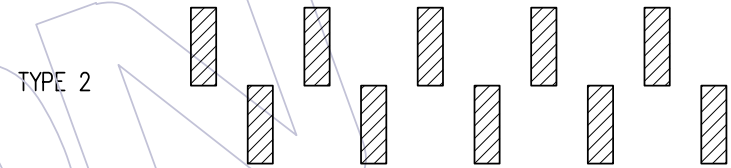
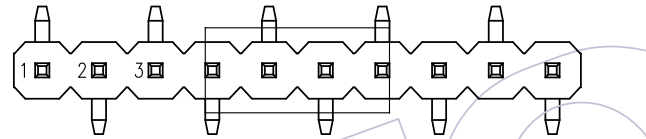
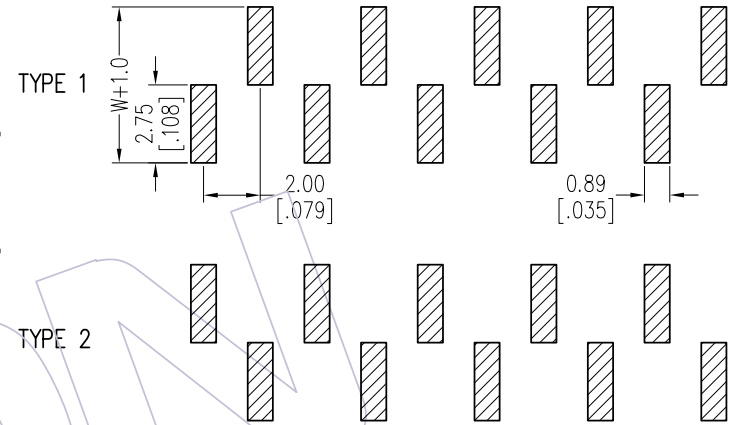
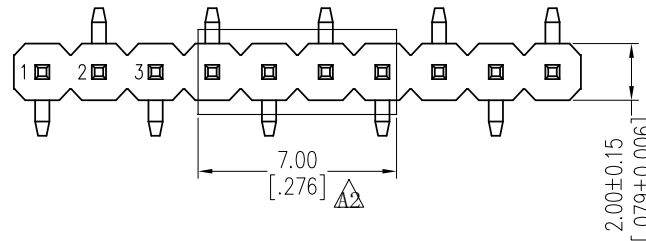

Ordering Information

1215-11 XX XX M XXX C R XX $\Delta\Delta$

No. of Pins	Contact Plating	Pin Length	Insulator Material	Packing	Series No.
02-40	G0=Gold Flash G3=10u"Gold G4=15u"Gold G5=30u"Gold S0=Gold Flash/Tin S3=10u"Gold/Tin S4=15u"Gold/Tin S5=30u"Gold/Tin SN=Tin SM=Matte Tin	L=B+D+1.5+ $\frac{W}{2}$ Standard:058=5.8 068=6.8 078=7.8	C=PA9T	T=Tube P=Tube+CAP R=Tape&Reel+CAP	01-99

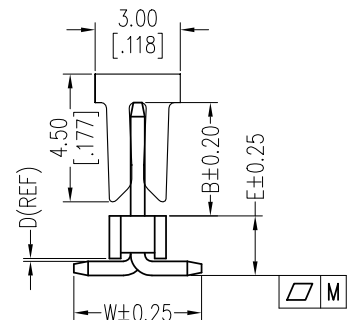
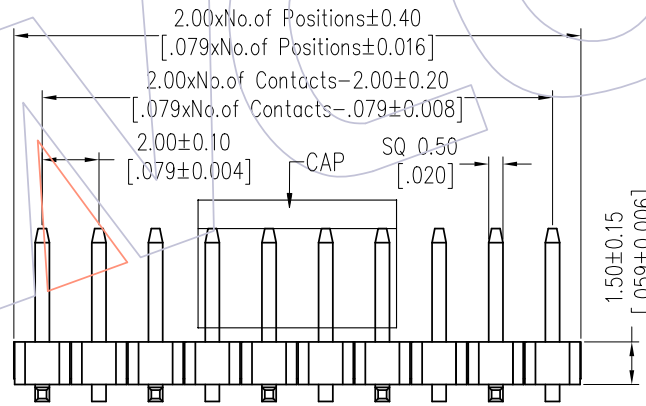

Item	Pin Length	W	E	B	Mating
Standard	5.80	4.50	2.10	2.00	2220T 2221 2227T 2228
	6.80	4.50	2.10	3.00	2235
	7.80	4.50	2.10	4.00	2240 2243 2263 2272
Alternate					

TITLE	PART NO.	SPEC. $\Delta\Delta$
PIN	2-15P	16-25P
M	0.10	0.15
	26-40P	
	TYPE 1	TYPE 2
	1215-11XXXXMXXXCX01	1215-11XXXXMXXXCX02
		DUAL/ODD PINS
		DUAL PINS

REV	DATE	MODIFICATION DESCRIPTION	CHANGE	OPERATION	DRAW	DATE	SCALE	Fit	PART NO.
A2	2019/07/20	Modify the CAP	$\Delta\Delta$	x.x ±0.40	<i>Ding</i>	2019/07/20	UNIT	mm	1215-11XXXXMXXXCXXX
A1	2018/01/18	Modify P/N	$\Delta\Delta$	x.xx ±0.25	CHECK	DATE	SIZE	A4	TITLE: PH2.00 SINGLE ROW SMT H=1.5
A0	2012/04/18	NEW	-----	x.xxx ±0.15	APPROVE	DATE	SHEET	1/1	Customer NO.
				Angle ± 3'			PROJ.		
				DIM TOL					

WCON
 Http: www.wcon.com
 WCON-Dongguan Tel: +86 769 85358920 Fax: +86 769 85358915 E-mail: sales@wcon.com
 WCON-Kunshan Tel: +86 512 57468408 Fax: +86 512 57468468 E-mail: salesks@wcon.com