

REV.	DESCRIPTION	DATE	APP'D
B	NPR 1757	4/5/00	

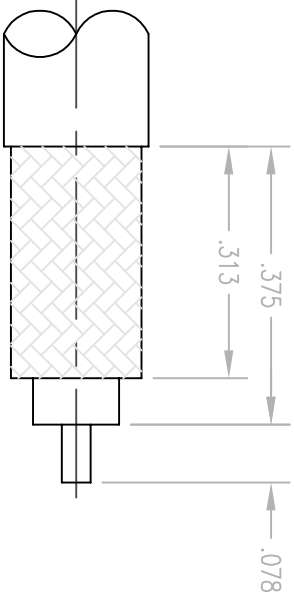
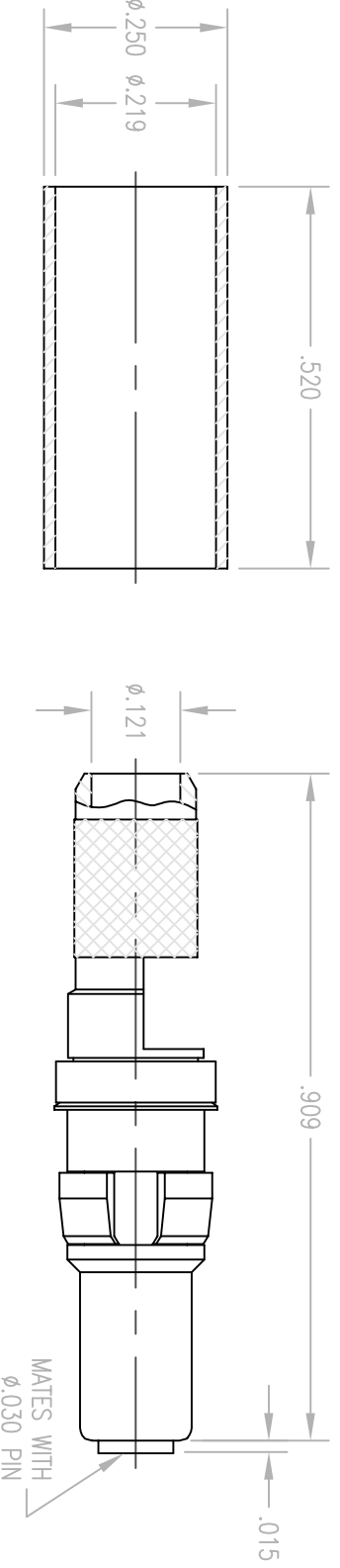

CABLE TRIMMING DIMENSIONS

- NOTES:
1. MATERIALS:
 CENTER CONTACT: BERYLLIUM COPPER PER ASTM B196
 CLIP RING: BERYLLIUM COPPER PER ASTM B194
 SPRING WASHER: PHOSPHOR BRONZE PER ASTM B103
 ALL OTHER METAL PARTS: BRASS PER ASTM B16
 INSULATOR: TEFLON PER ASTM D1710
 2. FINISH:
 BODY AND CENTER CONTACT: .000030 MIN. GOLD PER MIL-G-45204 OVER
 .000050 MIN. NICKEL PER QQ-N-290
 CLIP RING: .000100 MIN. NICKEL PER QQ-N-290
 OVER COPPER FLASH
 SPRING WASHER AND FERRULE: .000005 MIN. GOLD PER MIL-G-45204 OVER
 .000050 MIN. NICKEL PER QQ-N-290
 3. ELECTRICAL:
 IMPEDANCE: 50 OHMS NOMINAL
 4. DESIGNED FOR USE WITH RG-142 CABLE OR EQUIVALENT.
 5. FOR CABLING PROCEDURES USE CAP 9-01 WITH TRIMMING DIMENSIONS SHOWN.
 6. CRIMP FERRULE USING .213 HEX DIE.

PER ASME Y14.5M-1994 UNLESS OTHERWISE SPECIFIED: TOLERANCES ARE IN INCHES (MM) DECIMALS .XX ± .01/0.254 FRACTIONS .XXX ± .005/0.127 ANGLES ± Z° SCALE: 4:1		LITTON Winchester/Reticon 400 Park Road Westford, Connecticut 06096	
CUSTOMER DRAWING		TITLE RDM-HF STRAIGHT PLUG	
DRAWN JED DATE 4/3/00	CHECKED DATE	DATE A	SHT. 1 OF 1 REV. B
APPROVED DATE	APPROVED DATE	DATE A	210-910-1161G