

Rev	AWO #	Description	Date	Appr
-		RELEASED	12/01/10	

APPROVED: \_\_\_\_\_  
 DATE: \_\_\_\_\_ TITLE: \_\_\_\_\_

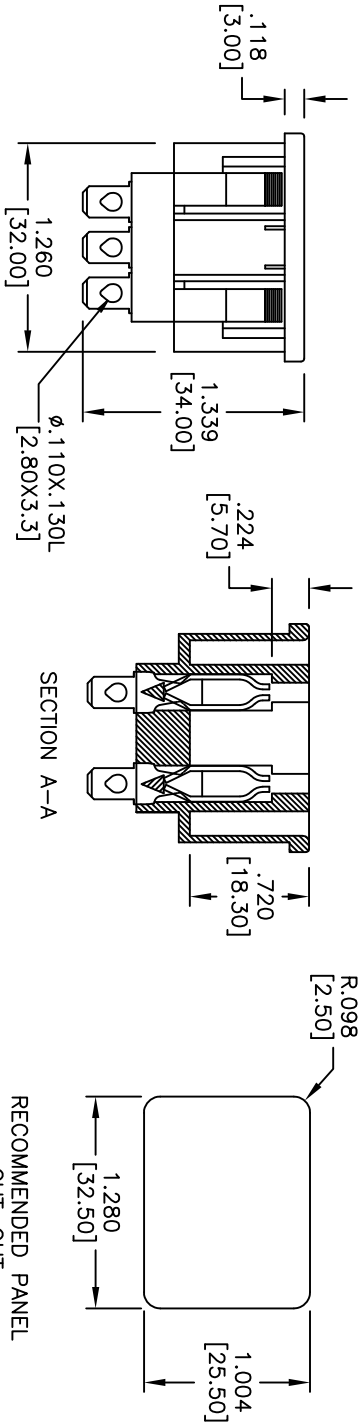
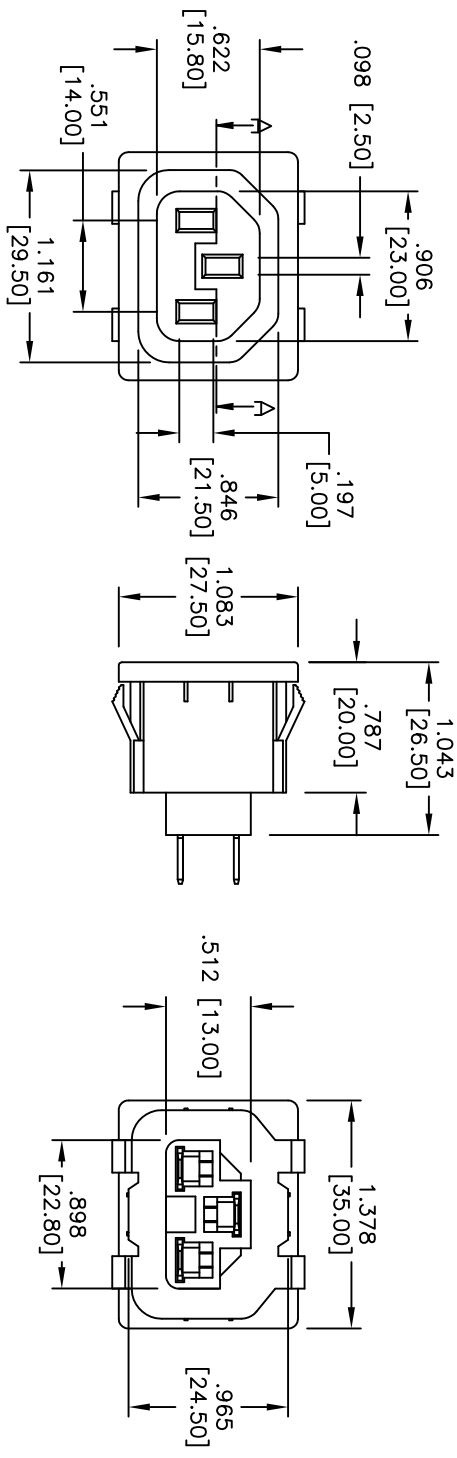

**SPECIFICATIONS:**

Material: Nylon 66, glass reinforced, rated UL 94V-0  
 Insulator color: Black  
 Contacts: Brass, Nickel plated  
 Plating: Tin over Copper underplate overall  
 Electrical:  
 Operating voltage: 250 VAC  
 Current rating: UL & CSA: 15 Amps max  
 VDE: 10 Amps max  
 Insulation resistance: 100 Mohms min @ 500 VDC  
 Dielectric withstanding voltage: 2,000 VAC for 1 minute  
 Temperature Rating:  
 Operating temperature: -25°C to +70°C  
 Environmental:  
 Lead free, RoHS compliant



**ADAM TECH**

909 Railway Avenue, Union, NJ 07083  
 Phone: 908-687-5000 Fax: 908-687-5710

TITLE: IEC FEMALE OUTLET, SNAP-IN  
 PANEL MOUNT, SPECIAL CONTACT

UNLESS OTHERWISE SPECIFIED ALL DIMENSIONS ARE INCHES [MM]		TOLERANCES EXCEPT AS NOTED	
INCHES	± .10	ØX	± .10
.XX	± .020	ØXXX	± .015
.XXX	± .015	ØXXX	± .010
APPROVALS	DATE		
DRAWN	DY	12/01/10	
CHECKED			
APPROVED			

SIZE	PART NO.	REV.
X	IEC-D-1-EF-C2	-
REF:	S00037T	
SCALE:	NTS	
SHEET	1 OF 1	