

# GSD

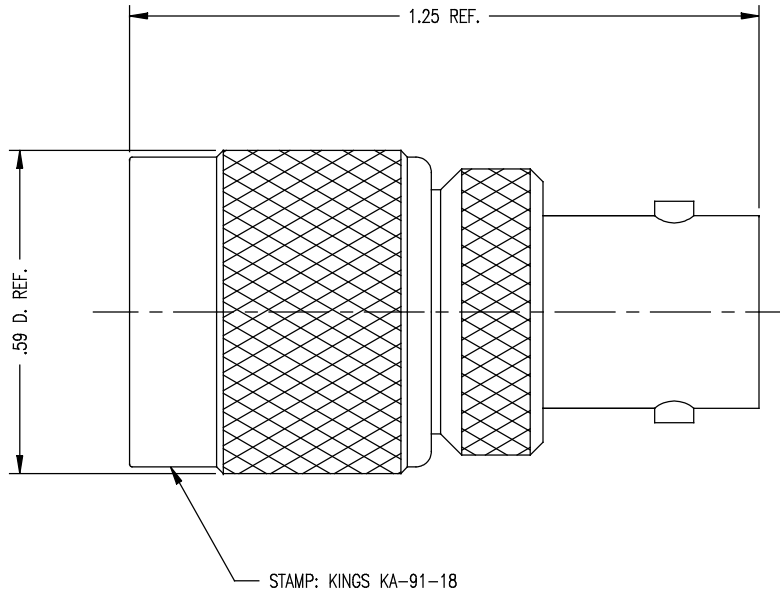

**NOTES:**

1. INTERFACES PER MIL-STD-348, 313-1 & 301-2.
2. MATERIALS:
  - INSULATOR: TEFLON, ASTM-D-4894
  - GASKET: SILICONE RUBBER, ZZ-R-765
  - OUTER CONTACT } BER. COP., ASTM-B-196
  - CENTER CONTACT }
  - ALL OTHER METAL PARTS: BRASS, ASTM-B16
3. FINISHES:
  - ALL METAL PARTS: SILVER PLATE PER QQ-S-365
4. ELECTRICAL CHARACTERISTICS:
  - NOMINAL IMPEDANCE: 50 OHMS
  - FREQUENCY RANGE: DC TO 4 GHZ
  - WORKING VOLTAGE: 500 VRMS

KA-91-18

**REVISIONS**

ISSUE	CHANGES
9	CN 36129 C REDRAWN ME 02/23/95
10	CN 37136 E KH 09/20/96

QGS0191

SCALE	4:1	
APPROX SURFACE AREA		
USED ON		
REF:	ADPT, M-F, TNC-BNC	
DRAWN	ME	DATE 02/23/95
DESIGN	MJB	DATE 02/24/95
APPR.		DATE

# GSD

**KINGS**  
ELECTRONICS CO., INC.  
TUCKAHOE, NEW YORK 10707

KA-91-18