

SMD Nonshielded type

▼ Shape & Dimensions / Recommended Solder Land Pattern

(Dimensions in mm)

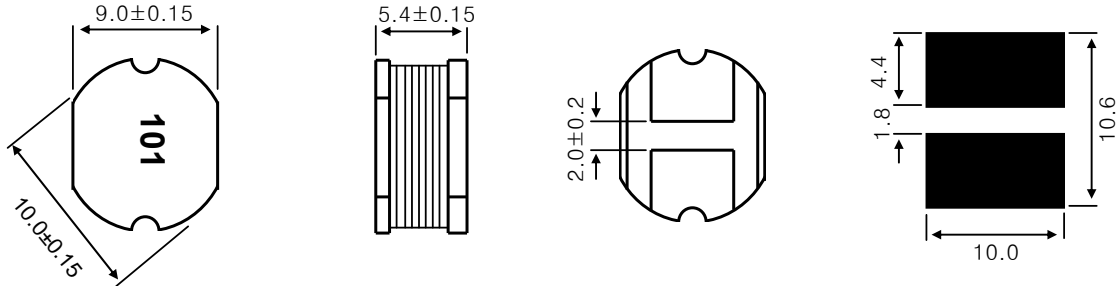

▼ Electrical Characteristics

Ordering Code	Inductance		Freq.	DC Resistance(Ω)	Rated DC current(A)
	L (uH)	Tol. (%)	F (KHz)	Rdc (Max.)	
LPN1054T-100K	10	±10	100	0.06	2.60
LPN1054T-150K	15			0.08	2.27
LPN1054T-220K	22			0.10	1.95
LPN1054T-330K	33			0.12	1.50
LPN1054T-470K	47			0.17	1.28
LPN1054T-680K	68			0.22	1.11
LPN1054T-101K	100			0.35	0.97
LPN1054T-151K	150			0.47	0.78
LPN1054T-221K	220			0.73	0.66
LPN1054T-331K	330			1.15	0.52
LPN1054T-471K	470			1.48	0.42
LPN1054T-681K	680			2.25	0.28

▼ Test Equipments

- . L : Agilent E4980A Precision LCR Meter
- . Rdc : HIOKI 3540 mΩ HiTESTER
- . Idc : Agilent 4284A LCR Meter + Agilent 42841A Bias Current Source

▼ Test Condition

- . L(Frequency , Voltage) : F=100 (KHz) , V=0.5 (V)
- . Idc(The saturation current) : $\Delta L \leq 10\%$ typical at rated current
- ※ Rated DC current : Idc

▼ Operating Temperature Range

-20 ~ +85 °C (Including self-generated heat)