

REV	DESCRIPTION	DR DATE	APPD
B	ECN 2364	1/27/00	<i>[Signature]</i>

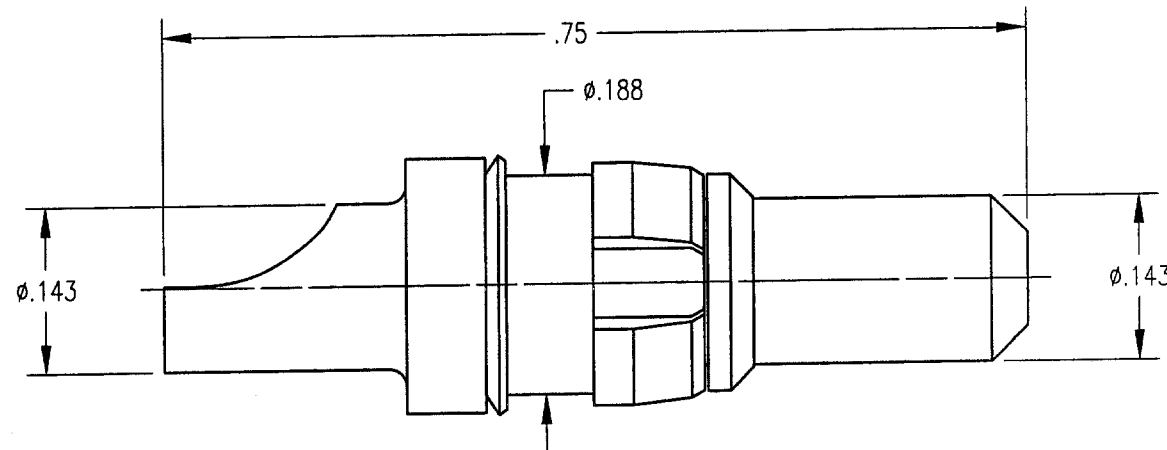

NOTES:

1. MATERIAL:
  - BODY: BRASS PER ASTM B16
  - SPRING WASHER: PHOSPHOR BRONZE PER ASTM B103
  - CLIP RING: BERYLLIUM COPPER PER ASTM B194
2. FINISH:
  - BODY: .000030 MIN. GOLD PER MIL-G-45204  
OVER .000050 MIN. NICKEL PER QQ-N-290
  - WASHER: .000005 MIN. GOLD PER MIL-G-45204  
OVER .000050 MIN. NICKEL PER QQ-N-290
  - CLIP RING: .000100 MIN NICKEL PER QQ-N-290
3. FOR USE WITH 12 AWG WIRE.

PER ASME Y14.5M-1994 UNLESS OTHERWISE SPECIFIED: DIMENSIONS ARE IN INCHES (MM)				<b>Litton</b> Winchester/Retconn 460 Park Road Wallingford, Connecticut 06795			
TOLERANCES: DECIMALS .XX ± .01/0.254 .XXX ± .005/0.127 ANGLES ± 2° SCALE: 6:1				TITLE RDM HIGH POWER PLUG 10/20 AMP			
<b>CUSTOMER DRAWING</b>				SHEET 1 OF 1			
DRAWN E.J.W.	DATE 1/7/98	CHECKED J.M.C.	DATE 1/7/98	APPROVED PRP	DATE 1/7/98		
<b>A</b> 220-510-0009G				REV. B			